

SULLY 650SX 4C

Manual

4-COLOUR LED PROFILE SPOT

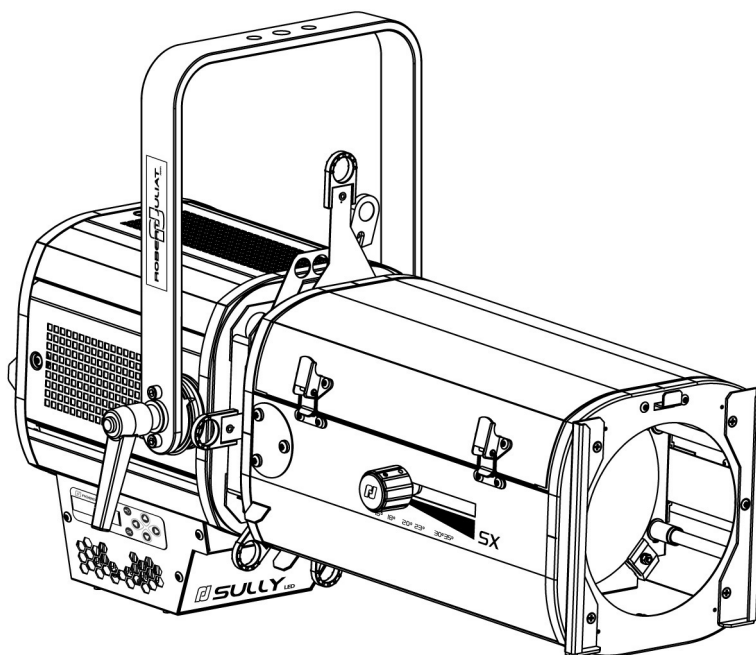

200 W LED

| Angles | Standard | North American |
|----------|----------|----------------|
| 28 - 54° | 653SX 4C | 653CSX 4C |
| 16 - 35° | 654SX 4C | 654CSX 4C |
| 11 - 26° | 651SX 4C | 651CSX 4C |

Product
Updates:



V2

- FIRMWARE: V2.xx



ROBERT JULIAT

DN41222400-B (EN)

Released: 15/12/25

Robert Juliat S.A.S. 32, rue de Beaumont, F 60530 Fresnoy-en-Thelle - phone: +33 (0)3 44 26 51 89 - info@robertjuliat.fr

www.robertjuliat.com

Table of Contents

| | | | |
|--|-----------|---|-----------|
| 1 User's instructions | 1 | 4.10 Beam size adjustment | 24 |
| 2 Presentation | 2 | 4.10.1 Range..... | 24 |
| 2.1 Functions..... | 2 | 4.10.2 Control..... | 24 |
| 2.2 Identification labels..... | 2 | 4.11 Orientation | 25 |
| 2.2.1 Label on LED compartment..... | 2 | 4.11.1 Range..... | 25 |
| 2.2.2 Label on lighting unit..... | 3 | 4.11.2 Control..... | 25 |
| 2.3 Accessories included..... | 3 | 4.12 Colour and diffuser filters (gels) | 25 |
| 2.4 Accessories..... | 4 | 4.13 Beam shaping | 26 |
| 3 Set-up | 5 | 4.13.1 Range..... | 26 |
| 3.1 Mechanics | 5 | 4.13.2 Control..... | 26 |
| 3.1.1 Operating positions..... | 5 | 4.14 Beam rotation | 27 |
| 3.1.2 Minimum distance between a flammable material..... | 5 | 4.14.1 Range..... | 27 |
| 3.1.3 Instructions for use..... | 5 | 4.14.2 Control..... | 27 |
| 3.1.4 Hanging..... | 5 | 5 Controls and parameters | 28 |
| 3.1.5 Safety cable..... | 6 | 5.1 Local display and controls | 28 |
| 3.2 Electrical information | 6 | 5.1.1 Display..... | 28 |
| 3.2.1 LED source..... | 6 | 5.1.2 Home screen..... | 28 |
| 3.2.2 Power supply..... | 6 | 5.1.3 Menu..... | 29 |
| 3.3 DATA | 7 | 5.1.4 Parameters..... | 30 |
| 3.3.1 DMX 512-A / RDM..... | 7 | 5.1.4.1 Backlight..... | 30 |
| 3.4 Accessories | 8 | 5.2 DMX512 - A remote control | 30 |
| 3.4.1 Front filter holder..... | 8 | 5.2.1 Protocol..... | 30 |
| 3.4.2 Double-condenser set..... | 8 | 5.2.2 Configuration..... | 30 |
| 3.4.3 Internal filter holder..... | 9 | 5.2.3 Parameters..... | 31 |
| 3.4.4 Gobo holder / Iris..... | 9 | 5.2.3.1 DMX Hold..... | 31 |
| 3.4.5 Optical filter..... | 10 | 5.2.3.2 User ID..... | 32 |
| 3.4.6 Shutters..... | 10 | 5.2.3.3 Transfer settings..... | 32 |
| 4 Operations | 11 | 5.2.4 DMX chart..... | 33 |
| 4.1 Source type | 11 | 5.2.5 DMX ranges..... | 33 |
| 4.1.1 Range..... | 11 | 5.2.5.1 Strobe duration..... | 33 |
| 4.1.2 Control..... | 11 | 5.2.5.2 Strobe speed..... | 33 |
| 4.2 Light intensity | 12 | 5.2.5.3 Response time..... | 33 |
| 4.2.1 Range..... | 12 | 5.2.5.4 Control mode..... | 34 |
| 4.2.2 Control..... | 12 | 5.2.5.5 Source Type..... | 34 |
| 4.2.3 Parameters..... | 12 | 5.2.5.6 Gel Type..... | 35 |
| 4.2.3.1 Dimming resolution - DMX only..... | 12 | 5.2.5.7 Gel references..... | 35 |
| 4.2.3.2 Dimming curve..... | 12 | 5.2.5.8 Gel Saturation..... | 35 |
| 4.2.3.3 Dimming mode..... | 13 | 5.2.5.9 Gel Transmission..... | 35 |
| 4.2.3.4 Response time..... | 13 | 5.2.5.10 Gel Fade Time..... | 35 |
| 4.2.3.5 DimShift..... | 13 | 5.2.5.11 Gel Fade Mode..... | 36 |
| 4.2.3.6 Set maximum position..... | 13 | 5.2.5.12 CCT..... | 36 |
| 4.3 Colour mix | 14 | 5.2.5.13 DeltaUV..... | 36 |
| 4.3.1 Range..... | 14 | 5.2.5.14 Colour CIE x..... | 36 |
| 4.3.2 Control..... | 15 | 5.2.5.15 Colour CIE y..... | 36 |
| 4.3.3 Parameters..... | 16 | 5.3 RDM remote control | 36 |
| 4.3.3.1 Colour space selection..... | 16 | 5.3.1 Protocol..... | 36 |
| 4.3.3.2 High Quality / High Brightness..... | 17 | 5.3.2 PIDs list..... | 37 |
| 4.4 Colour Temperature CCT | 17 | 5.3.3 Parameters..... | 38 |
| 4.4.1 Range..... | 17 | 5.4 Fan cooling modes | 38 |
| 4.4.2 Control..... | 18 | 5.4.1 Range..... | 38 |
| 4.4.3 Parameters..... | 18 | 5.4.2 Control..... | 38 |
| 4.4.3.1 High Brightness / High Quality..... | 18 | 5.5 LEDs Feedback | 39 |
| 4.4.3.2 DimShift..... | 18 | 5.5.1 Trouble shooting..... | 39 |
| 4.5 High Brightness / High Quality | 18 | 5.5.2 Parameters..... | 39 |
| 4.5.1 Range..... | 18 | 5.5.2.1 Auto-OFF..... | 39 |
| 4.5.2 Control..... | 18 | 5.6 Home values | 40 |
| 4.6 Colour filters | 19 | 5.6.1 Range..... | 40 |
| 4.6.1 Range..... | 19 | 6 Service | 41 |
| 4.6.2 Control..... | 19 | 6.1 Preventive maintenance | 41 |
| 4.6.3 Parameters..... | 20 | 6.1.1 Frequency..... | 41 |
| 4.6.3.1 Saturation..... | 20 | 6.1.2 General cleaning..... | 41 |
| 4.6.3.2 Transmission..... | 20 | 6.1.3 General visual check..... | 41 |
| 4.6.3.3 Gel Fade Time and Mode..... | 21 | 6.1.4 LED source..... | 41 |
| 4.7 Strobe | 22 | 6.1.5 Optics..... | 41 |
| 4.7.1 Range..... | 22 | 6.1.6 LED house cleaning..... | 41 |
| 4.7.2 Control..... | 22 | 6.1.7 LED module cleaning procedure..... | 42 |
| 4.8 Response time | 22 | 6.2 Analysis | 44 |
| 4.8.1 Range..... | 22 | 6.3 Electronic thermal management system | 44 |
| 4.8.2 Control..... | 22 | 6.4 Firmware update | 44 |
| 4.9 DimShift | 23 | 6.5 Factory defaults | 45 |
| 4.9.1 Range..... | 23 | 6.5.1 Modes..... | 45 |
| 4.9.2 Control..... | 24 | 6.5.2 Control..... | 45 |
| | | Annex 1 - Gel References..... | 46 |
| | | Annex 2 - Home values..... | 47 |

1 User's instructions

GENERAL INSTRUCTIONS

1. Not for residential use.
2. These fixtures must only be serviced by a qualified technician.
3. In addition to the instructions indicated on this page, relevant health and safety requirements of the appropriate EU Directives must be adhered to at all times.
4. This fixture is in compliance with section 17 - Lighting appliance for theatre stages, television, cinema and photograph studios.
Standards NF EN 60598-1, NF EN 60598-2-17, Low Voltage Directive 2014/35/UE & EMC Directive 2014/30/UE.
5. This fixture is rated as IP20, and is for indoor use only.

FIXTURE

6. Ensure fixture is correctly mounted on an appropriate support.
7. Protection screens and lenses must be replaced in the event of any damage, such as cracks or deep scratches, since these might reduce performance.
8. When hung or flown the fixture must be secured by an additional hanging accessory (such as a safety cable or bond) of suitable length.
9. Safety bonds or cables must be securely attached to the back of the fixture and be as short as possible, or rolled up as necessary, to minimise travel distance should the fixture be dislodged.
10. Movable accessories (scroller, etc.) must also be secured with a suitable safety cable or bond at the front of the fixture.
11. The combined weight of both the fixture and the accessories must be considered when choosing the load-bearing capability of safety cable or bond.
12. Do not open lighting fixture when the source is on.
13. WARNING: LED source becomes hot during use. Allow fixture to cool before servicing.
14. Do not tamper with design of fixture nor any of its safety features.
15. Tighten electrical mains cable connections regularly and replace with one of identical specification if damaged.
16. Use only with correct power supply.

VENTILATION

17. Keep well away from flammable material.
18. Not for outdoor use. Do not cover. Do not permit fixture to get wet.
19. To avoid overheating, do not obstruct air vents.
20. Ensure any cooling fans are in correct working order. If fans are not working, turn fixture off immediately and service as necessary.

CLEANING

21. Do not touch the LED source with your fingers.
22. To clean the optical parts, use a soft cloth in combination with distilled water or isopropyl alcohol recommended for coated optics. Do not use any cleaning product that contains solvents or abrasives, as these can cause surface damage. Dry with a soft lint-free cloth.
23. Regularly remove dust with a soft lint-free cloth.
24. If the fixture has filters, they must be cleaned frequently.

POWER SUPPLY

25. Disconnect from the mains before servicing.
26. Mains connection only. Do not connect to "electronic output" such as dimmer.
27. Ensure power supply circuit breakers, always remain accessible.

PLEASE NOTE

This product has been built to conform to European standards relating to professional lighting equipment. Any modification made to our products will void the manufacturers' warranty.

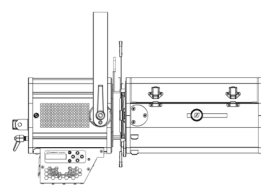
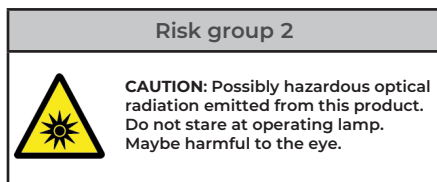

Photobiological safety according to EN62471

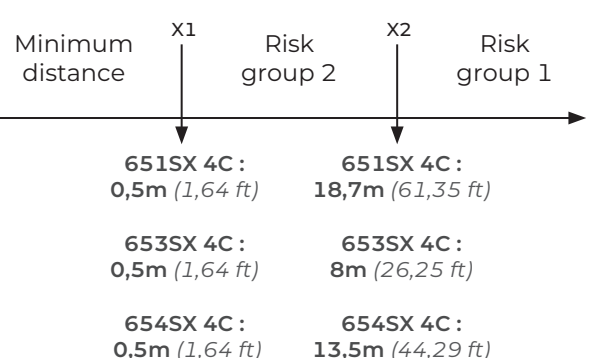

Group risk 2. Luminaires should be positioned so that prolonged staring into luminaire at a distance closer than 18,7m (651SX 4C), 8m (653SX 4C) & 13,5m (654SX 4C) is not expected.

2 Presentation

2.1 Functions

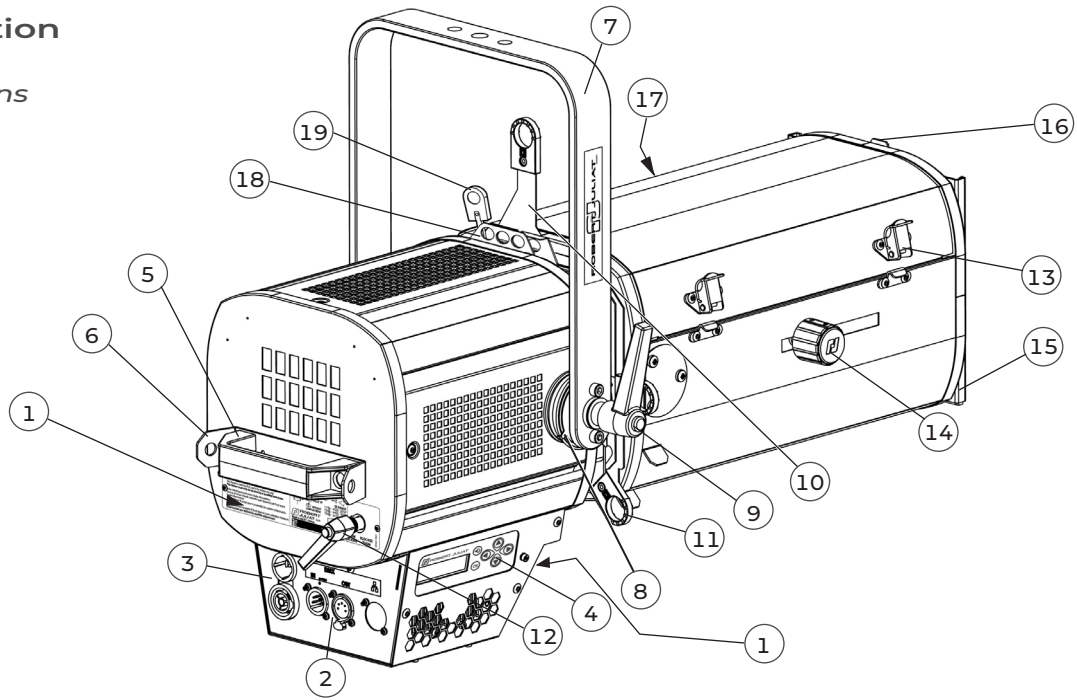

| Description | |
|----------------------------------|---|
| 1. Identification plates | 11. Shutter locking system |
| 2. Data connector (IN and OUT) | 12. Lens tube rotation locking button |
| 3. Power connector (IN and OUT) | 13. Lens tube access |
| 4. Local display and controls | 14. Focus adjustment |
| 5. Handle | 15. Front slot for accessories and gel frame holder |
| 6. Safety cable attachment point | 16. Front slot locking system |
| 7. Hanging yoke | 17. Zoom adjustment |
| 8. Tilt index | 18. Gobo holder |
| 9. Tilt locking handle | 19. Iris |
| 10. Shutters | |

2.2 Identification labels

2.2.1 Label on LED compartment

| Description | |
|---|---|
| | <p>1. MOD. : Model</p> <p>2. VERS. : Version</p> <p>3. U : Nominal voltage input (V)</p> <p>4. I : Nominal intensity (A)</p> <p>5. P : Maximum power input (W)</p> <p>6. IP : International Protection Rating</p> <p>7. t^a : Maximum ambient temperature (°C)</p> <p>8. t^c : Maximum external temperature of the unit (°C)</p> <p>9. Net weight (kg)</p> <p>10. Minimum distance between a flammable material and the lighting unit (m)</p> <p>11. LED type</p> <p>12. Serial number</p> <p>13. Replace broken glass</p> <p>14. Class 1 product label</p> <p>15. Read manual first label</p> <p>16. European conformity label</p> <p>17. WEEE directive label</p> <p>18. CEI-TR-62778 - Do not stare at light source</p> <p>19. EN62471 - Risk group</p> <p>20. UKCA (UK Conformity Assessed) label</p> |
| <p>Units :</p> <ul style="list-style-type: none"> - Weight = kilogram (kg). - Intensity = Ampere (A). - Voltage = Volt (V). - Frequency = Hertz (Hz). - Temperature = degree Celsius (°C). | |

Description

Disconnect from mains supply before servicing. Both source and housing become hot during use, allow fixture to cool before servicing.

Keep well away from flammable material. Do not cover. This fixture is rated as IP20, and is for indoor use only. This fixture must only be serviced by a qualified technician.

● *Isoler électriquement avant toute intervention. Source et corps chauds, attendre que l'appareil soit froid avant toute intervention. Ne pas placer le projecteur à proximité de matière inflammable. Ne pas couvrir. Cet appareil est considéré IP20 et réservé à une utilisation intérieure. Intervention par technicien qualifié uniquement.*

1. Model beam angles
2. Net weight (kg) without LED compartment
3. Serial number
4. Class 1 product label
5. Read manual first label
6. European conformity label
7. WEEE directive label
8. Operating positions
9. UKCA (UK Conformity Assessed) label

Units :

- Weight = kilogram (kg).
- Intensity = Ampere (A).
- Voltage = Volt (V).
- Frequency = Hertz (Hz).
- Temperature = degree Celsius (°C).

2.3 Accessories included

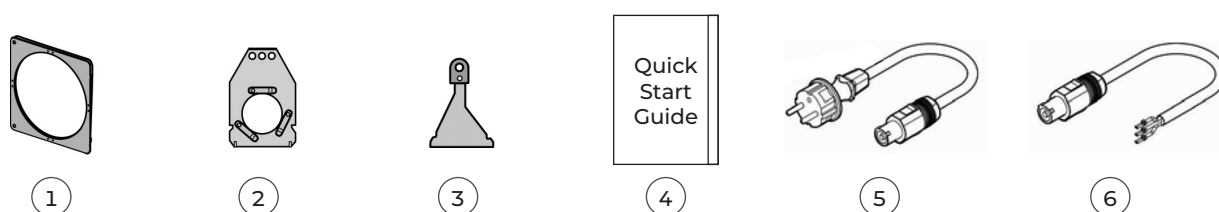

| | Reference | Description |
|---|------------|---|
| 1 | PF500M2 | 180 x 180 mm (7.1 x 7.1 in) metal filter holder |
| 2 | SGUX | Universal A-size gobo holder (metal, glass, frosted glass) |
| 3 | D8 | Shutter (x4) |
| 4 | DN41222600 | Quick Start manual |
| 1 | CAL03 | 3 meter power cable (3G1,5 HO7RNF) with Neutrik PowerCon® True1 TOP and CEE 7/7 (2P+T NF/SCHUKO) connectors (standard version) |
| 2 | CAL04 | 1,50m power cable UL/CSA with Neutrik PowerCon® True1 TOP connector (North American version) |

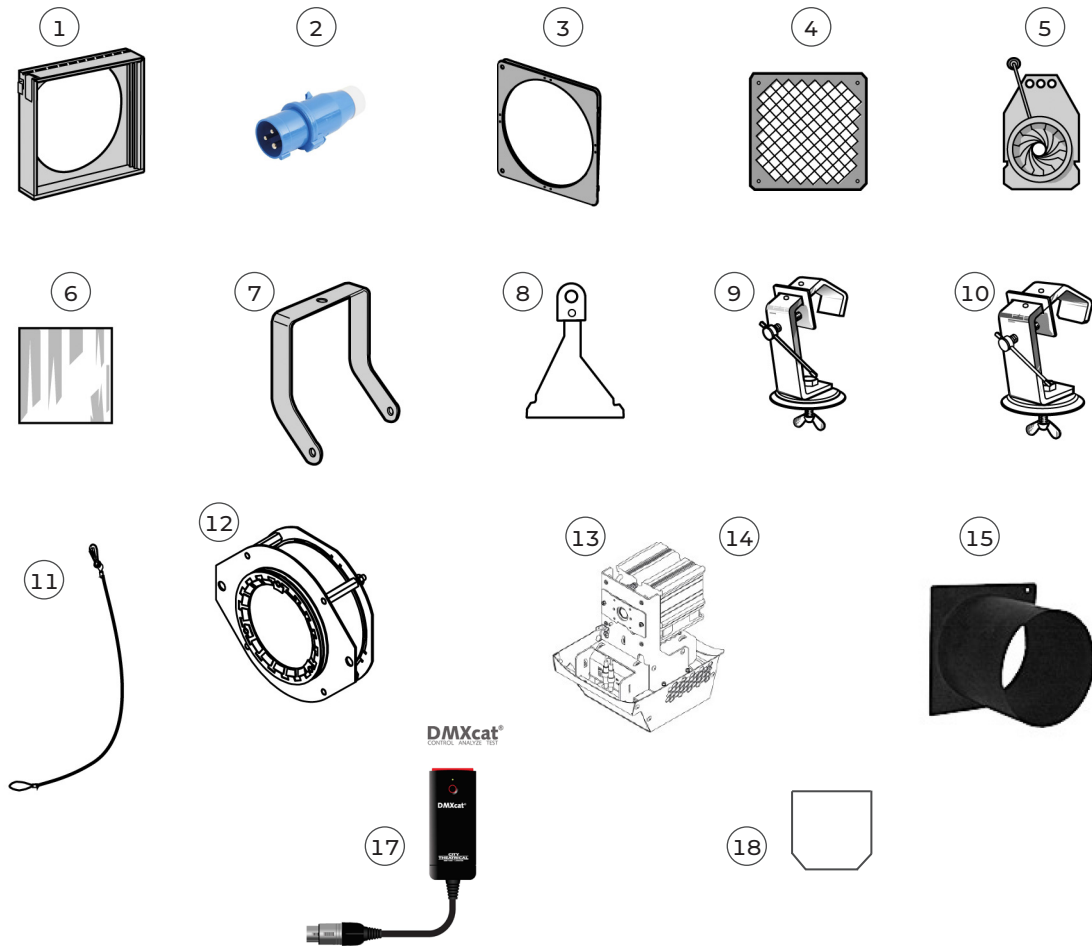

| | Reference | Description |
|----|-----------|--|
| 1 | CAV 600A | Double slot front cassette for 180 x 180 mm accessories |
| | CAV 600AE | Double slot front cassette for 185 x 185 mm accessories |
| 2 | PCP1716A | 16A blue 2P+E 6h IEC60309 power connector |
| 3 | PF600M2 | 185 x 185 mm (7.28 x 7.28 in) metal filter holder |
| 4 | G500 | 180 x 180 mm safety grid |
| 5 | IWSX755 | Drop-in iris (monoplane) with holder |
| 6 | VD 120 | 120x120mm frosted glass |
| | FO120C-1 | 120x120mm 1° frost optical filter |
| | FO120C-10 | 120x120mm 10° frost optical filter |
| | FO120C-2 | 120x120mm 2° frost optical filter |
| | FO120C-5 | 120x120mm 5° frost optical filter |
| 7 | FCD600 | Angled yoke |
| 8 | D8 | Shutter |
| 9 | 876 | Hook clamp 40 x 10 mm with 28 mm M10 screw for Ø35 to Ø50 mm pipes |
| 10 | 880 | Hook clamp 40 x 10 mm with 28 mm M10 screw for Ø50 to Ø63 mm pipes |
| 11 | CS2 | Safety cable Ø3 mm (length = 600 mm) |
| 12 | APH 68LED | Double-condenser set for Led profile |
| 13 | T/650SXCW | SULLY 115 W LED compartment - Cool White - 3 meter power cable with CEE 7/7 (2P+T NF/SCHUKO) connector |
| 14 | T/650SXWW | SULLY 115 W LED compartment - Warm White - 3 meter power cable with CEE 7/7 (2P+T NF/SCHUKO) connector |
| 15 | TH600 | 180 x 180 mm "Top hat" (without safety cable) |
| 16 | FO100-10 | Ø97 mm optical filter for coloured LED source - type 10 |
| 17 | DMXcat | Bluetooth DMX/RDM Multifunction test tool - City Theatrical DMXcat® |

3 Set-up

3.1 Mechanics

3.1.1 Operating positions

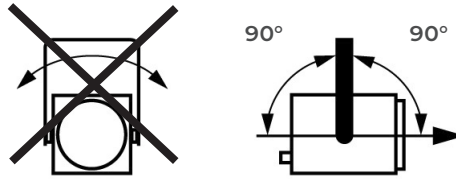

3.1.2 Minimum distance between a flammable material and the lighting unit

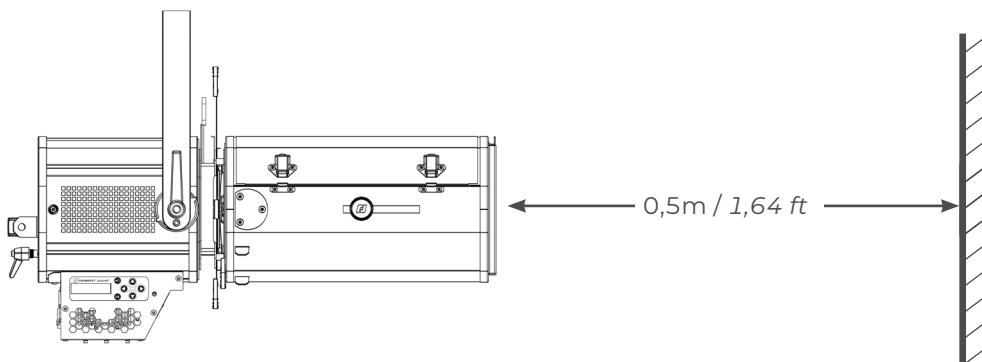

3.1.3 Instructions for use

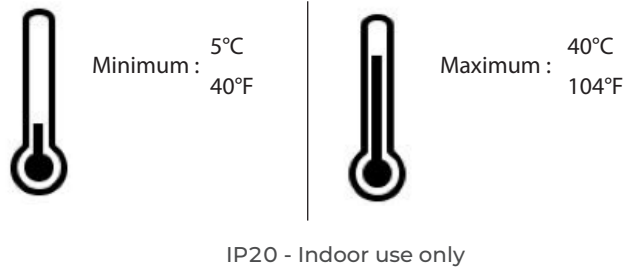

3.1.4 Hanging

- Ensure fixture is correctly mounted on an appropriate support

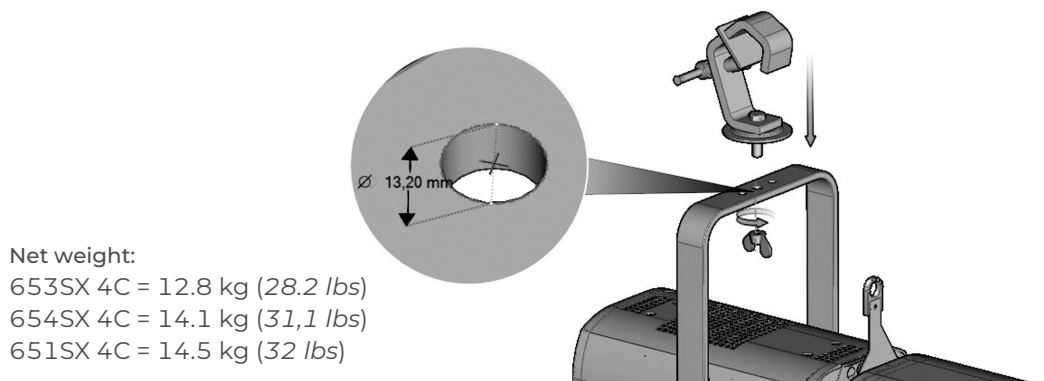

3.1.5 Safety cable

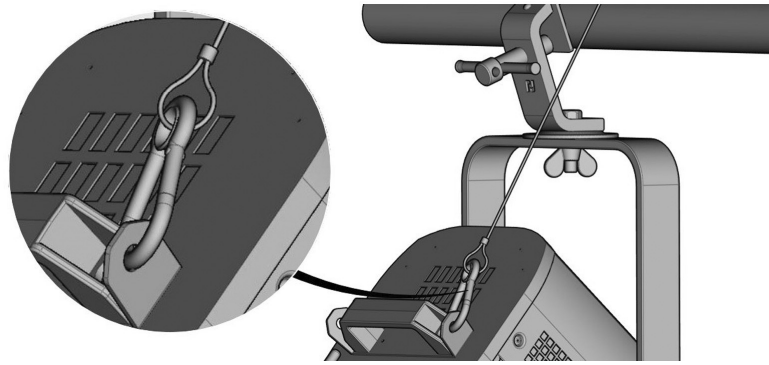

- When hung or flown the fixture must be secured by an additional hanging accessory (such as a safety bond or cable) of suitable length.
- The combined weight of both the fixture and the accessories must be considered when choosing the load-bearing capability of safety cable or bond.
- Safety cables or bonds must be securely attached to the back of the fixture and be as short as possible, or rolled up as necessary, to minimise travel distance should the fixture be dislodged.

3.2 Electrical information

3.2.1 LED source



Never touch or scratch the LED surface.
See 6.1.4 LED cleaning procedure if cleaning is necessary.

3.2.2 Power supply

| Power supply | | | |
|--------------|-----------|---|---|
| Voltage | Frequency | Input power | Connectors |
| 100 → 264 V | 50-60 Hz | 0.88 A / 175 W @ 230V cos γ = 0,87 1.67 A / 178 W @ 110V cos γ = 0,98 1.82 A / 178 W @ 100V cos γ = 0,99 180 W max, Max: 2.1 A | Neutrik powerCON TRUE1 TOP Input : ref. NAC3FPX-TOP |



- Class 1 product. **This luminaire must be earthed.**
- Must be connected directly to AC power. **Do not connect to dimmer power.**
- Automatic mains voltage detection.

Daisy chain (with delivered power cable):

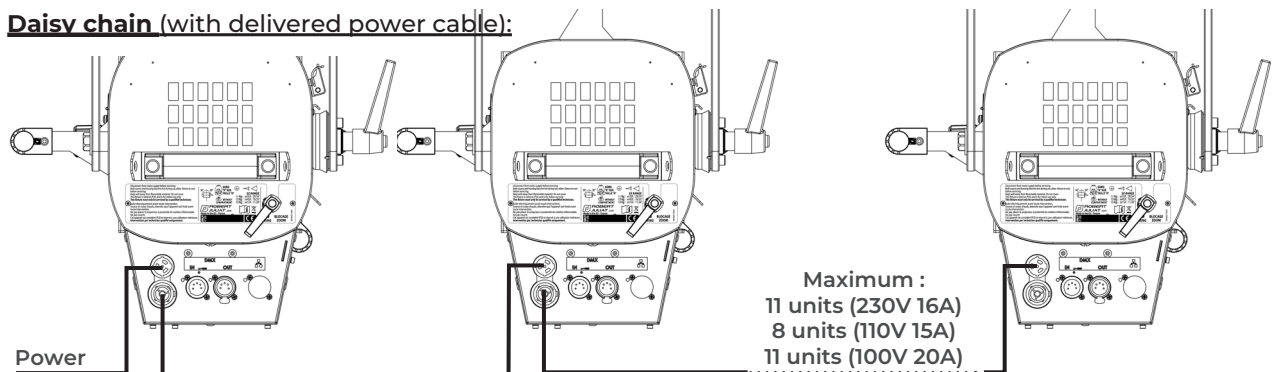

Power cable

| Power cable | Connector | Mains plug | Cable type | Cable length | Wiring |
|--------------------------|--|------------|------------------------|-----------------|--|
| 1 Standard version | Neutrik® powerCON TRUE1 TOP NAC3FX-W-TOP | CEE7/7 | 3G1.5 H07RNF | 3 m 9.8 ft | Live: Brown Neutral: Blue Ground: Yellow/Green |
| 2 North American version | | - | 14AWG SJ TYPE (UL/CSA) | 1.5 m 4.9 ft | Live: Black Neutral: White Ground: Green |

3.3 DATA

3.3.1 DMX 512-A / RDM

| Protocol | Input connector | Output connector |
|------------------------|-----------------|------------------|
| USITT DMX 512-A RDM | XLR 5-pin | XLR 5-pin |

| DATA connectors | | | |
|-----------------|-----------|---|------------|
| PIN # | DMX | Description | Connectors |
| 1 | Shielding | Foil & Braided Shield | |
| 2 | DMX (-) | 1 st conductor of 1 st twisted pair | |
| 3 | DMX (+) | 2 nd conductor of 1 st twisted pair | |
| 4 | Not used | 1 st conductor of 2 nd twisted pair | |
| 5 | Not used | 2 nd conductor of 2 nd twisted pair | |

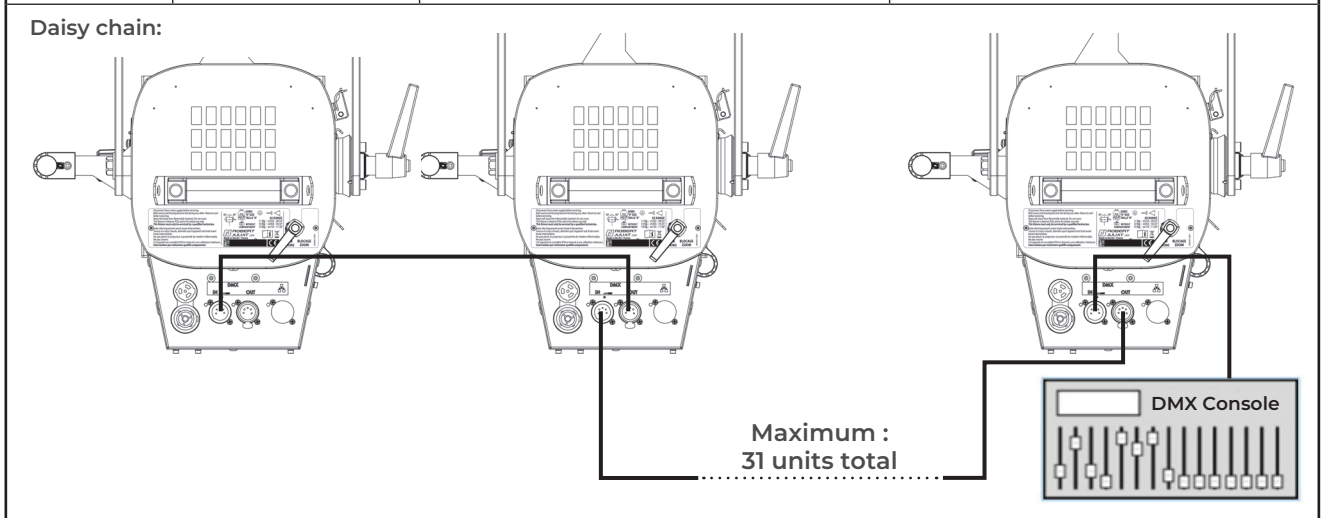

3.4 Accessories

3.4.1 Front filter holder

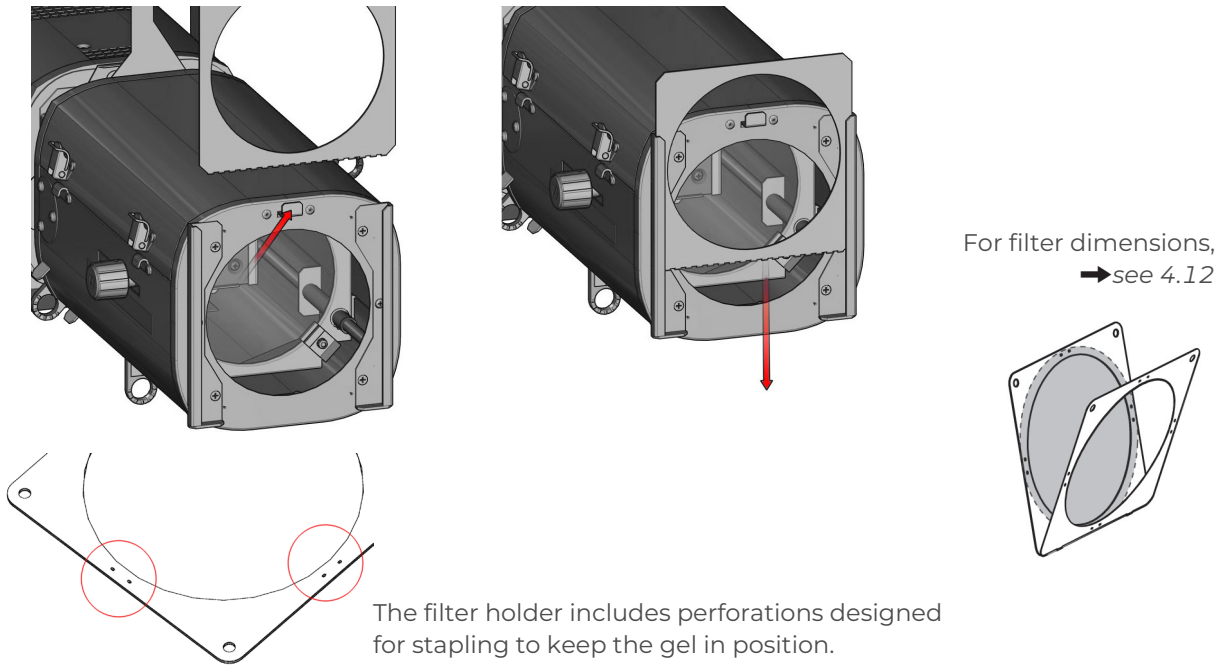

3.4.2 Double-condenser set

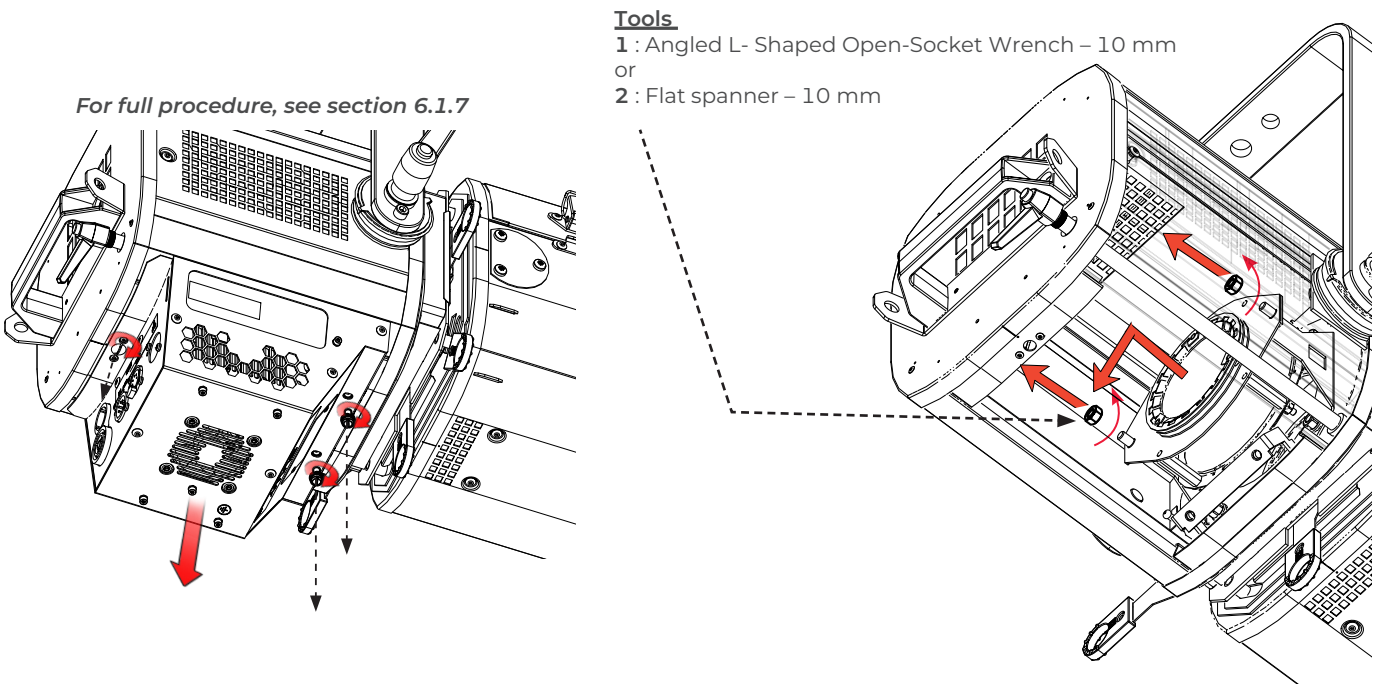

Only possible with LED version (not with halogen)

3.4.3 Internal filter holder

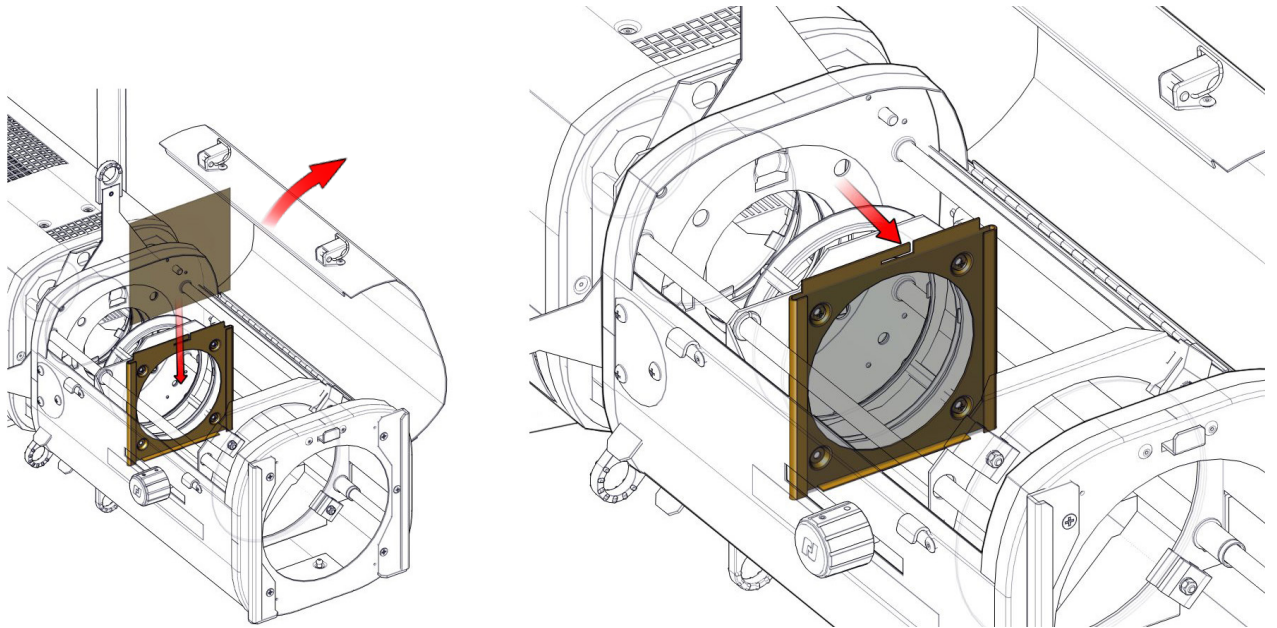

For filter dimensions,
→ see 4.12

ion 1

3.4.4 Gobo holder / Iris

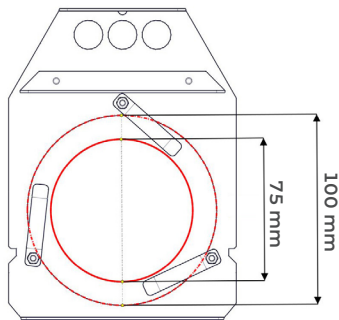

A-size
Metal / Glass / frosted glass

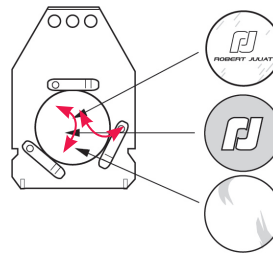

And/or:

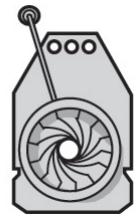

Position 1

Position 1 & 2

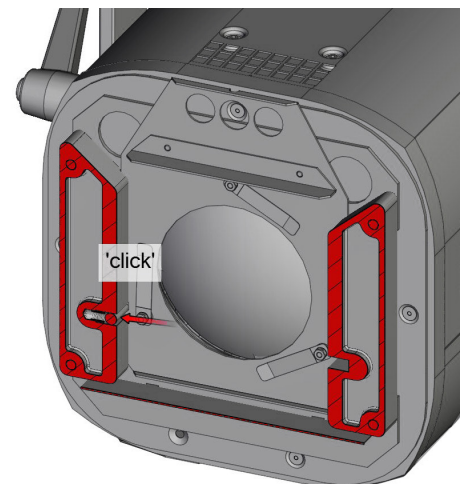
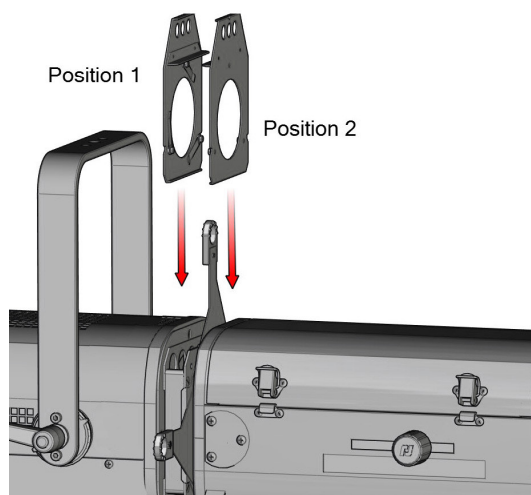

3.4.5 Optical filter

For filter dimension, see section 3.4.4

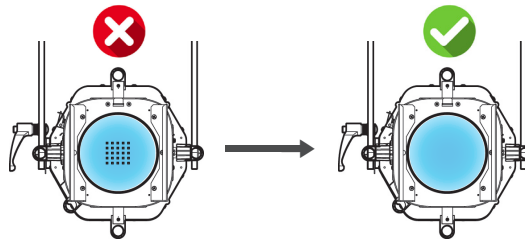
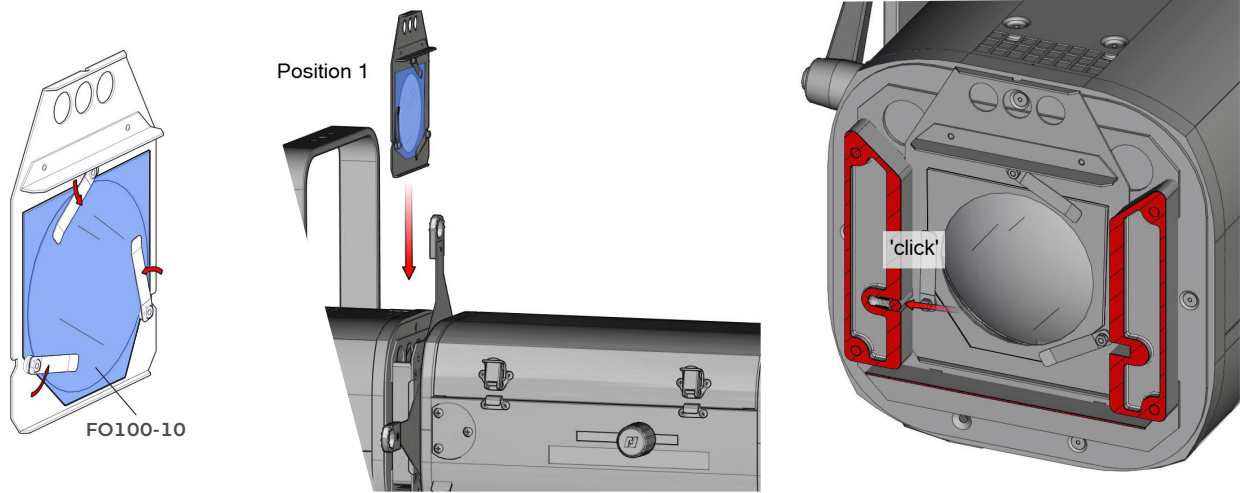

3.4.6 Shutters

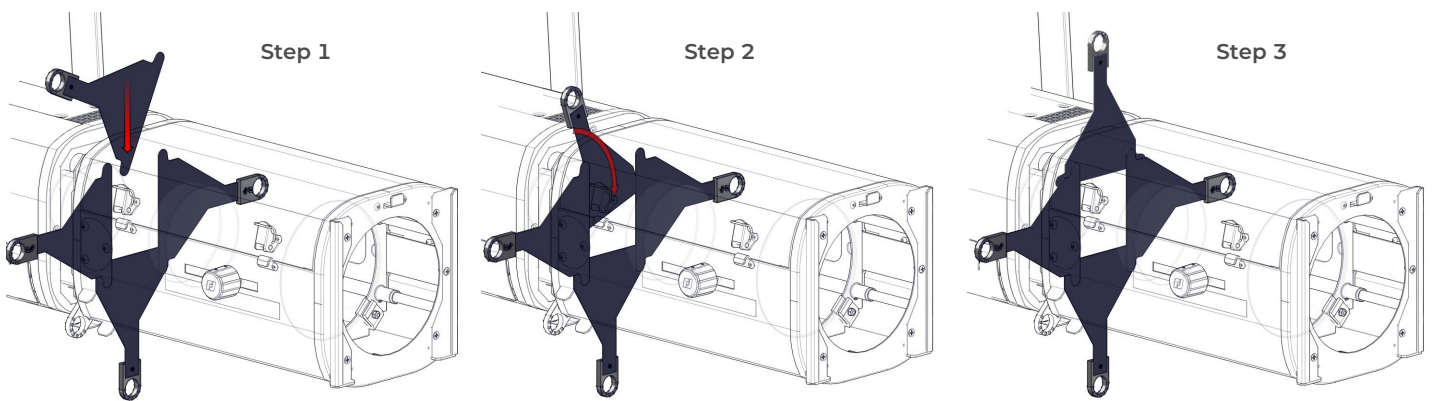

4.1 Source type

4.1.1 Range

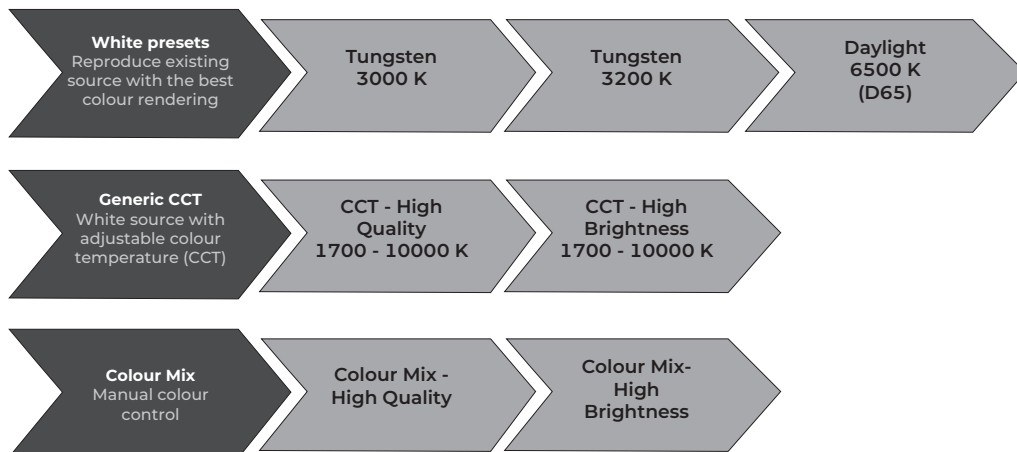

| Source type | Compatible functions | | | | | |
|--|----------------------|------------------------|-----------------|--------------|----------------|----------|
| | Colour Mix | Colour Temperature CCT | High Brightness | High Quality | Colour Filters | DimShift |
| | See 4.3 | See 4.4 | See 4.5 | See 4.5 | See 4.6 | See 4.9 |
| Tungsten 3200 K - DimShift | | | | X | X | X |
| Tungsten 3000 K - DimShift | | | | X | X | X |
| Tungsten 3200 K | | | | X | X | |
| Tungsten 3000 K | | | | X | X | |
| Daylight 6500 K (D65) | | | | X | X | |
| Generic CCT - High Quality | | X | | X | X | |
| Generic CCT - High Brightness | | X | X | | X | |
| Generic CCT - High Quality - DimShift | | X | | X | X | X |
| Generic CCT - High Brightness - DimShift | | X | X | | X | X |
| Colour Mix - High Quality | X | | | X | | |
| Colour Mix - High Brightness | X | | X | | | |

4.1.2 Control

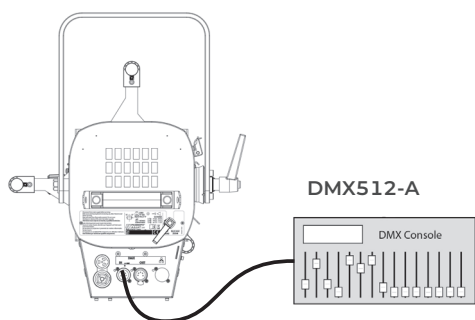

Remotely with DMX512-A protocol
 Mode 3 - 4 - 5 - 6
 (see 5.2.4 DMX chart for function details)

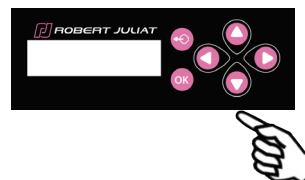

Locally with DMX mode 1 - 2 and
 Stand Alone mode - see 5.6 Home value

4.2 Light intensity

4.2.1 Range



4.2.2 Control

DMX512-A

DMX Console

Remotely with DMX512-A protocol
Mode 1 - 2 - 3 - 4 - 5 - 6
(see 5.2.4 DMX chart for function details)

Locally via
STAND ALONE mode

Focus mode: when standby screen displayed,
Push the UP arrow button for 3 secs → Light output = 100% for 1 minute
Push the UP arrow button to Exit → Light output = 0%

4.2.3 Parameters

4.2.3.1 Dimming resolution - DMX only

→ Set through RDM protocol, DMX control channel or local control

| Resolution | DMX mode |
|------------------------|-------------------|
| 8 bits - 255 steps | 1 |
| 16 bits - 65 535 steps | 2 - 3 - 4 - 5 - 6 |

4.2.3.2 Dimming curve

→ Set through RDM protocol or local control

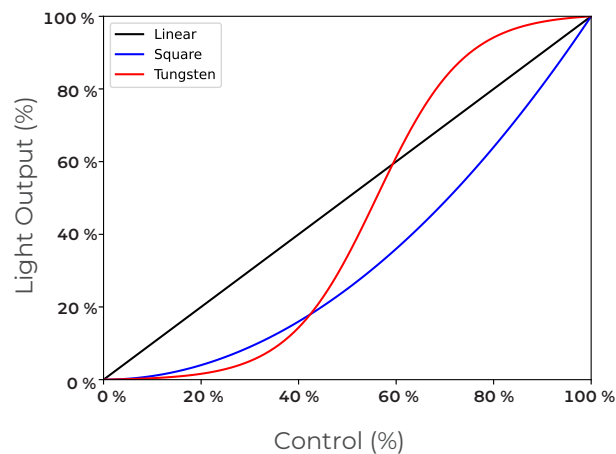

4.2.3.3 Dimming mode

➔ Set through RDM protocol or local control

| Mode | Frequency |
|------|--|
| PWM | 1282 Hz / 2500 Hz / 5000 Hz / 6000 Hz / 15000 Hz* / 20000 Hz |

(*) Default value

4.2.3.4 Response time

➔ See 4.8

4.2.3.5 DimShift

➔ See 4.9

4.2.3.6 Set maximum position

➔ Set through RDM protocol or local control

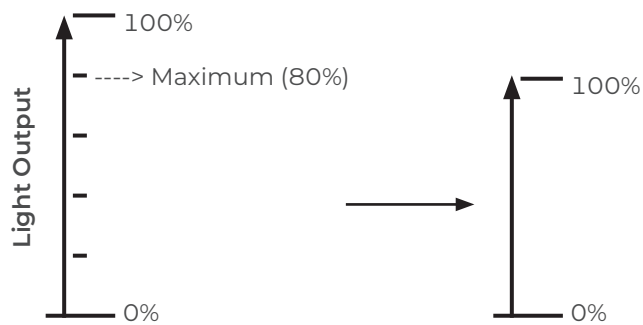

4.3.1 Range

CIE xy control (ANSI E1.54–2021)

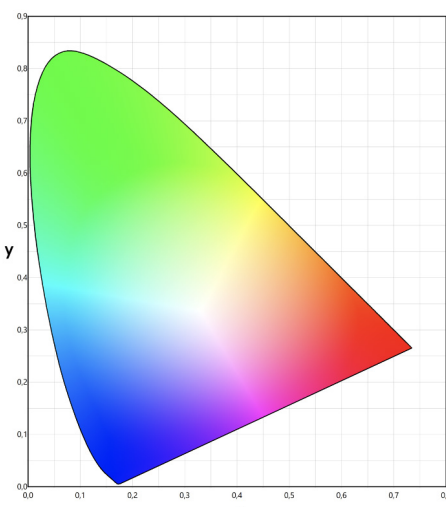

x = 0 → 0,85

y = 0 → 0,85

Colour space: CIE 1931 xy

RGB (ANSI E1.54–2015)

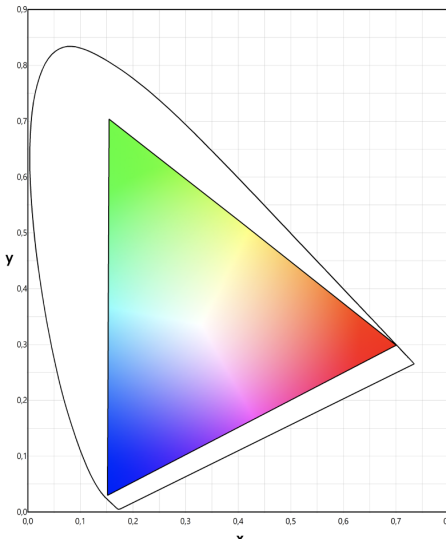

RED 0% 100%

GREEN 0% 100%

BLUE 0% 100%

Colour space:
NATIVE / SRGB-REC. 709 / REC. 2020 / PROPHOTO RGB
→ see 4.3.3

Hue Saturation (ANSI E1.54–2015)

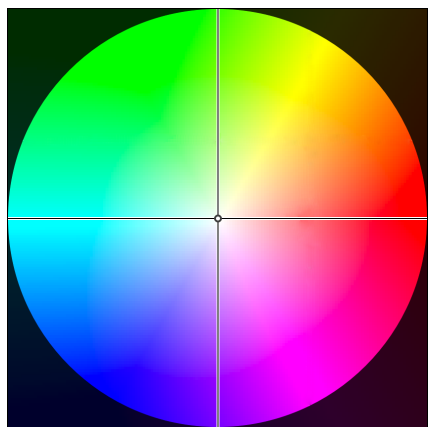

Hue = 0 → 360°
Hue of 0° = Full Red (RGB = 100,0,0)
Hue of 120° = Full Green (RGB = 0,100,0)
Hue of 240° = Full Blue (RGB = 0,0,100)

Saturation = 0 (white) → 100% (saturated colour)

Colour space:
NATIVE / SRGB-REC. 709 / REC. 2020 / PROPHOTO RGB
→ see 4.3.3

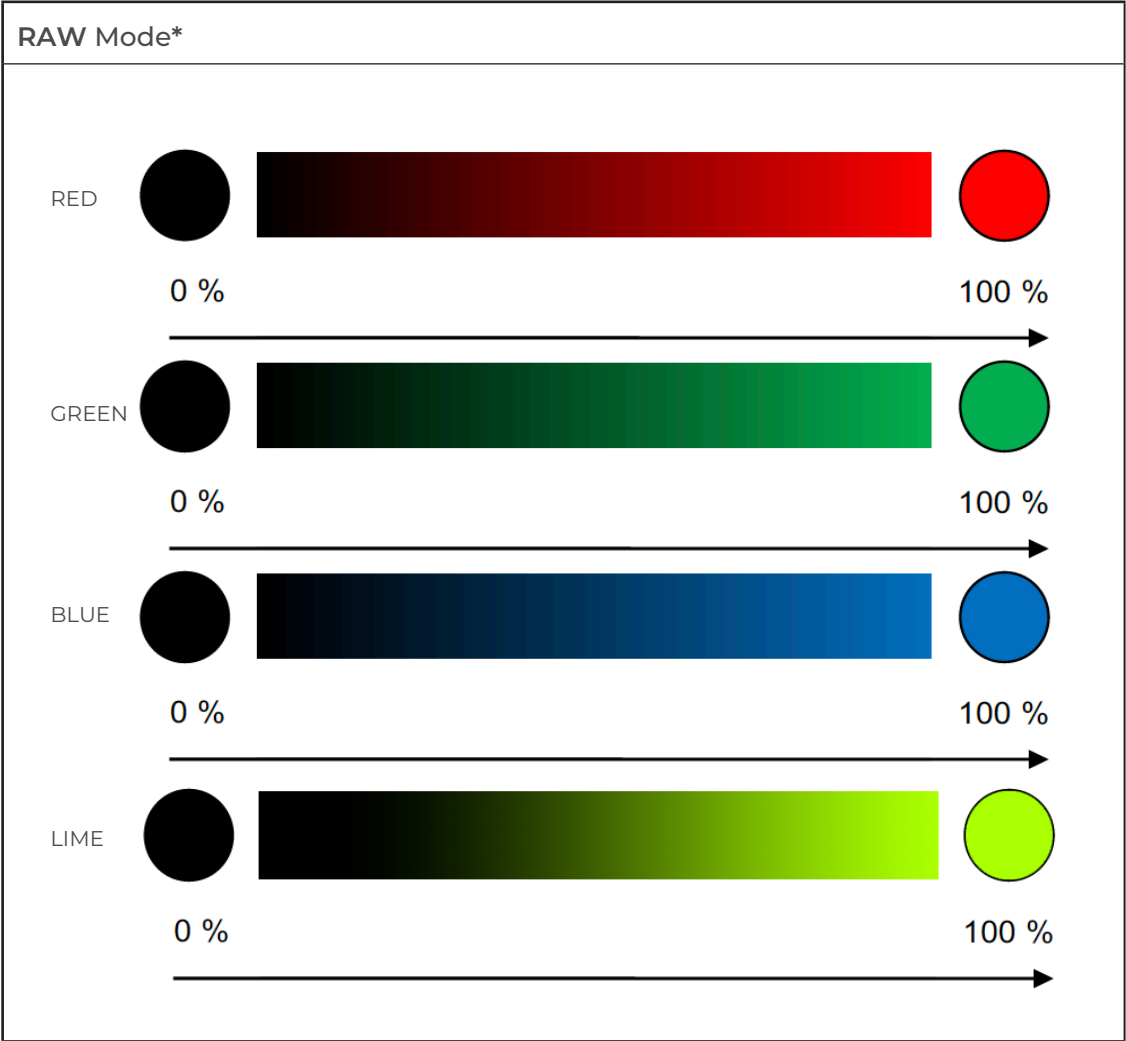

(*) Calibration disabled

4.3.2 Control

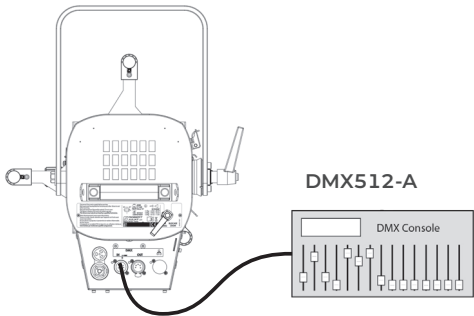

Remotely with DMX512-A protocol

| | |
|----------------|-----------------------------------|
| CIE xy | Mode 3 Source type = Colour Mix |
| Hue Saturation | Mode 4 Source type = Colour Mix |
| RGB | Mode 5 Source type = Colour Mix |
| RAW | Mode 6 Source type = Colour Mix |

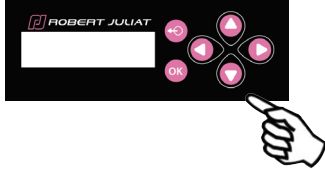

Locally via STAND ALONE mode - see 5.6 Home value

4.3.3 Parameters

4.3.3.1 Colour space selection

- ➔ Set through RDM protocol, DMX control channel or local control
- For RGB and Hue Saturation modes only

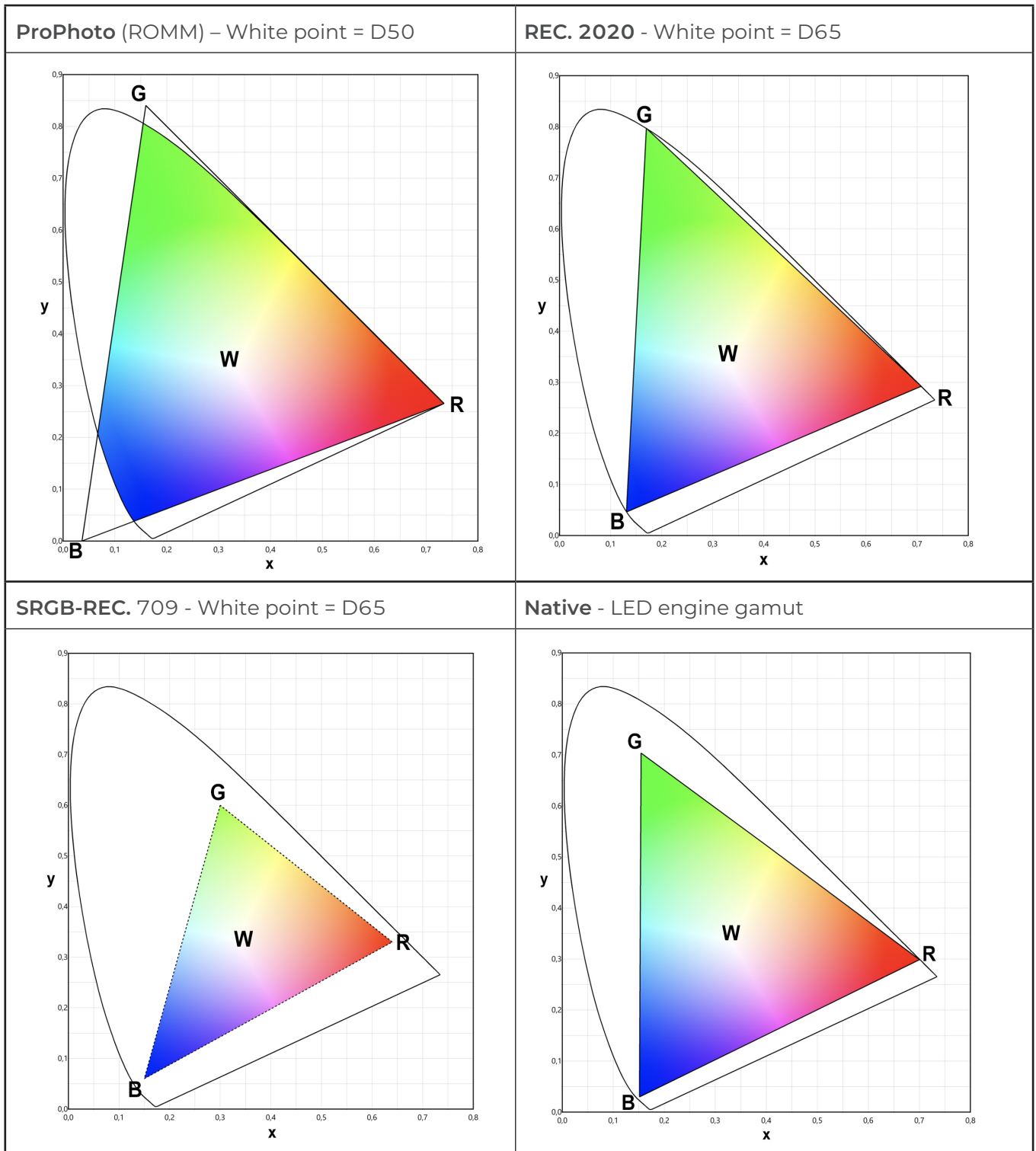

| Point | Red | Green | Blue |
|-----------------|-------|-------|-------|
| R | 100 % | 0 % | 0 % |
| G | 0 % | 100 % | 0 % |
| B | 0 % | 0 % | 100 % |
| W (White point) | 100 % | 100 % | 100 % |

➔ See 4.5

4.4 Colour Temperature CCT

4.4.1 Range

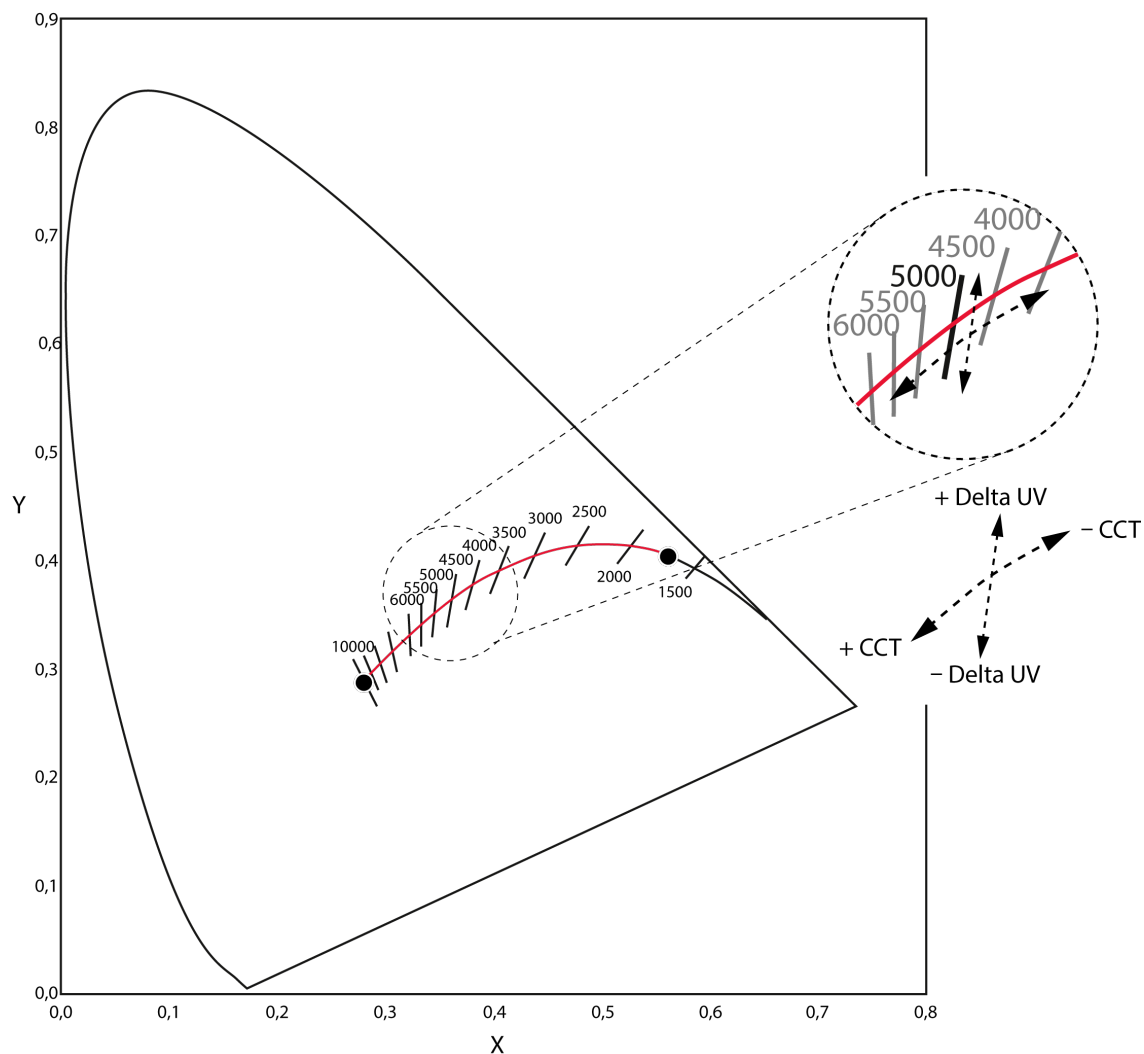

| | |
|------------------------|---|
| Colour Temperature CCT | <p>0% 100%</p> |
| | <p>1 700 Kelvin 10 000 Kelvin</p> |
| Delta UV | <p>-100% (Magenta) +100% (Green)</p> |
| | <p>0</p> |

4.4.2 Control

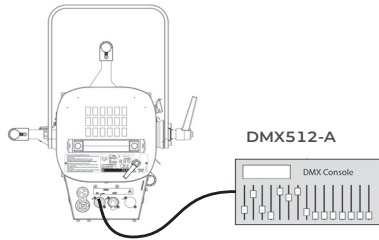

Remotely with DMX512-A protocol
 Mode 3 - 4 - 5 - 6 | Source type = Generic CCT
 (see 5.2.4 DMX chart for function details)

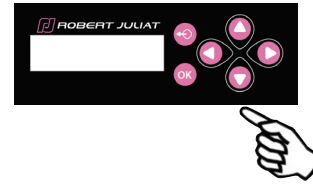

Locally with DMX mode 1 - 2 and
 Stand Alone mode - see 5.6 Home value

4.4.3 Parameters

4.4.3.1 High Brightness / High Quality
 → See 4.5

4.4.3.2 DimShift
 → See 4.9

4.5 High Brightness / High Quality

4.5.1 Range

| Mode | Light output | Colour rendering |
|----------------------|--------------|------------------|
| HB – High Brightness | + | – |
| HQ – High Quality | – | + |

Example : Generic CCT @ 5600K

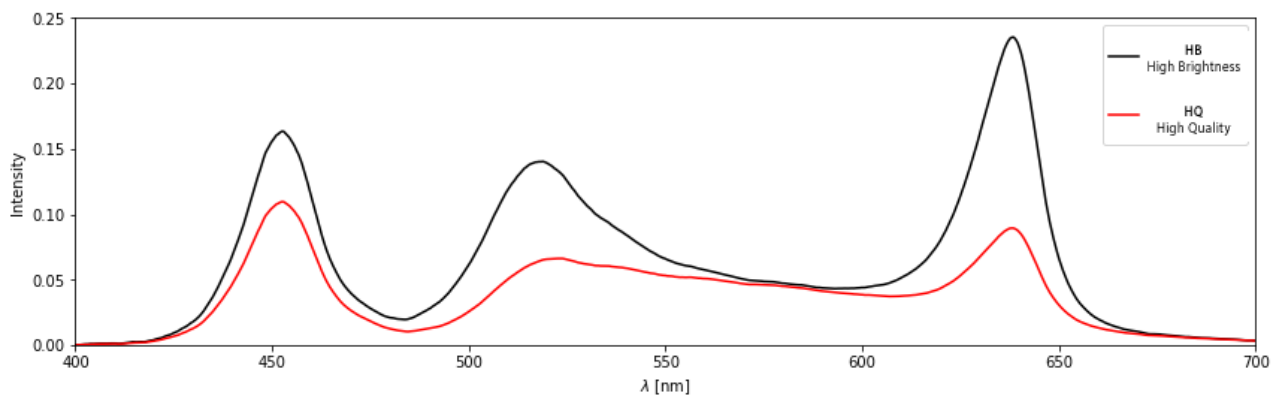

4.5.2 Control

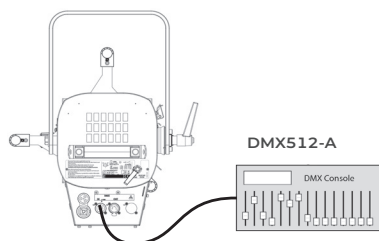

Remotely with DMX512-A protocol
 Mode 3 - 4 - 5 - 6 | Source type = Generic CCT /
 Colour Mix
 (see 5.2.4 DMX chart for function details)

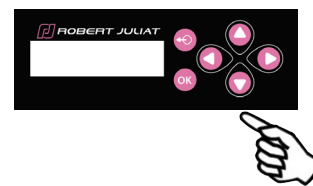

Locally with DMX mode 1 - 2 and
 Stand Alone mode - see 5.6 Home value

4.6.1 Range



(*) Results depend on Source type or Colour temperature - compatible with White presets, Generic CCT source types and DimShift function

4.6.2 Control

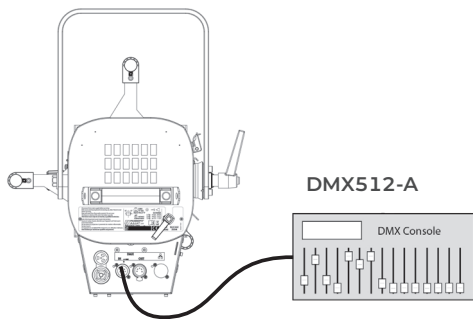

Remotely with DMX512-A protocol
 Mode 3 - 4 - 5 - 6 | Source type = White presets /
 Generic CCT
 (see 5.2.4 DMX chart for function details)

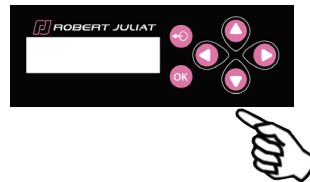

Locally with DMX mode 1 - 2 and
 Stand Alone mode - see 5.6 Home value

Colour filter selection:

1. Selection of the colour wheel

| | |
|----------|------------------------|
| Wheel 1 | Basics |
| Wheel 2 | Numeric: 002 --> 111 |
| Wheel 3 | Numeric: 113 --> 181 |
| Wheel 4 | Numeric: 182 --> 328 |
| Wheel 5 | Numeric: 332 --> 710 |
| Wheel 6 | Numeric: 711 --> 799 |
| Wheel 7 | Chroma: 048 --> 719 |
| Wheel 8 | Chroma: 711 --> 504 |
| Wheel 9 | Chroma: 730 --> 007 |
| Wheel 10 | Chroma: 765 --> 789 |
| Wheel 11 | Chroma: 787 --> 344 |
| Wheel 12 | Cosmetic & Corrections |
| Wheel 13 | Dalis selection |

2. Selection of the gel reference

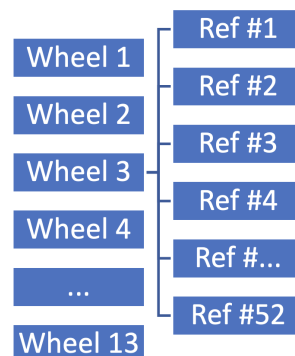

➔ See annex for reference details

4.6.3 Parameters

4.6.3.1 Saturation



4.6.3.2 Transmission



- ➔ Filter transmission is independant from main dimmer. Dimmer intensity can still be operated from 0 to 100% with or without the DimShift function

4.6.3.3 Gel Fade Time and Mode

Transition between 2 colour filters – Gel fade time:

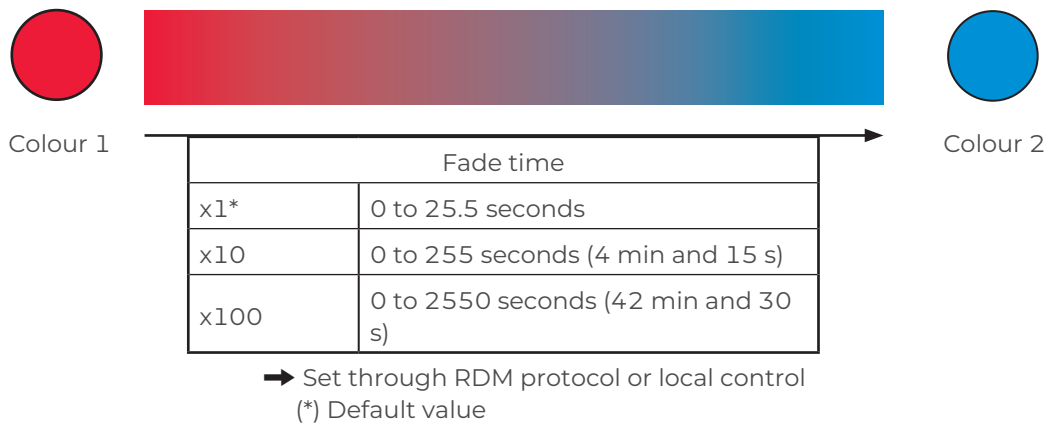

Transition between 2 colour filters - Gel Fade type:

| | |
|------------------------------------|--|
| Direct XY + Limit Brightness | |
| Direct XY | |
| Open Frame + Limit Brightness | |
| Open Frame | |
| Through Black | |

4.7.1 Range

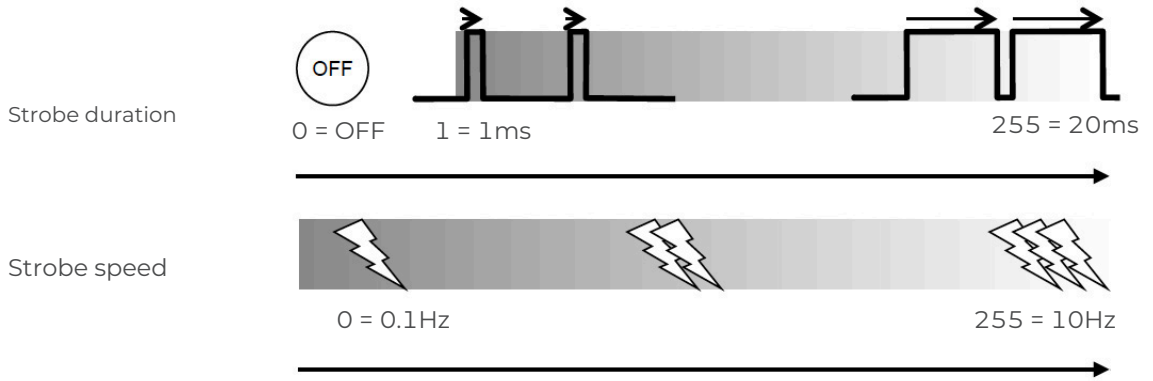

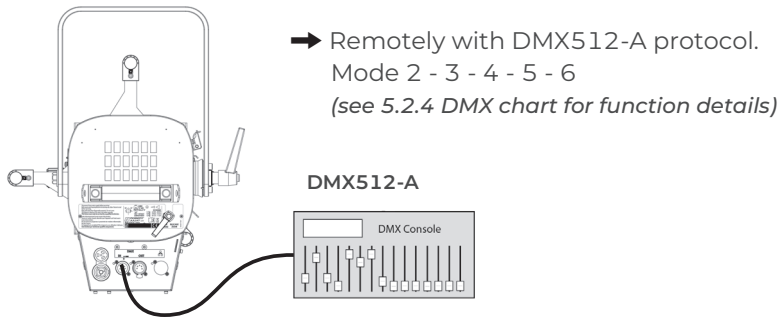

4.7.2 Control



4.8 Response time

4.8.1 Range

| Mode |    |
|------------------------|---|
| Default | 1000 W tungsten lamp simulation |
| Tungsten | 500 W ————— 5000 W |
| Linear | 0 s ————— 4 s |
| Linear / Flash by-pass | 0 s ————— 4 s Or If flash detected (>50% brightness variation) = 0 s |

4.8.2 Control

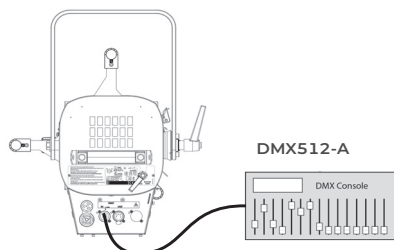

Remotely with DMX512-A protocol
Mode 2 - 3 - 4 - 5 - 6
(see 5.2.4 DMX chart for function details)

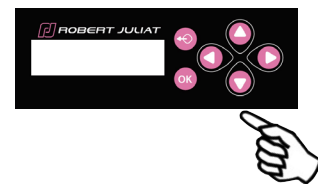

Locally with DMX mode 1 and
Stand Alone mode - see 5.6 Home value

4.9.1 Range

DimShift function:
When dimming the light, the colours follow the Planck curve (tungsten redshift emulation)

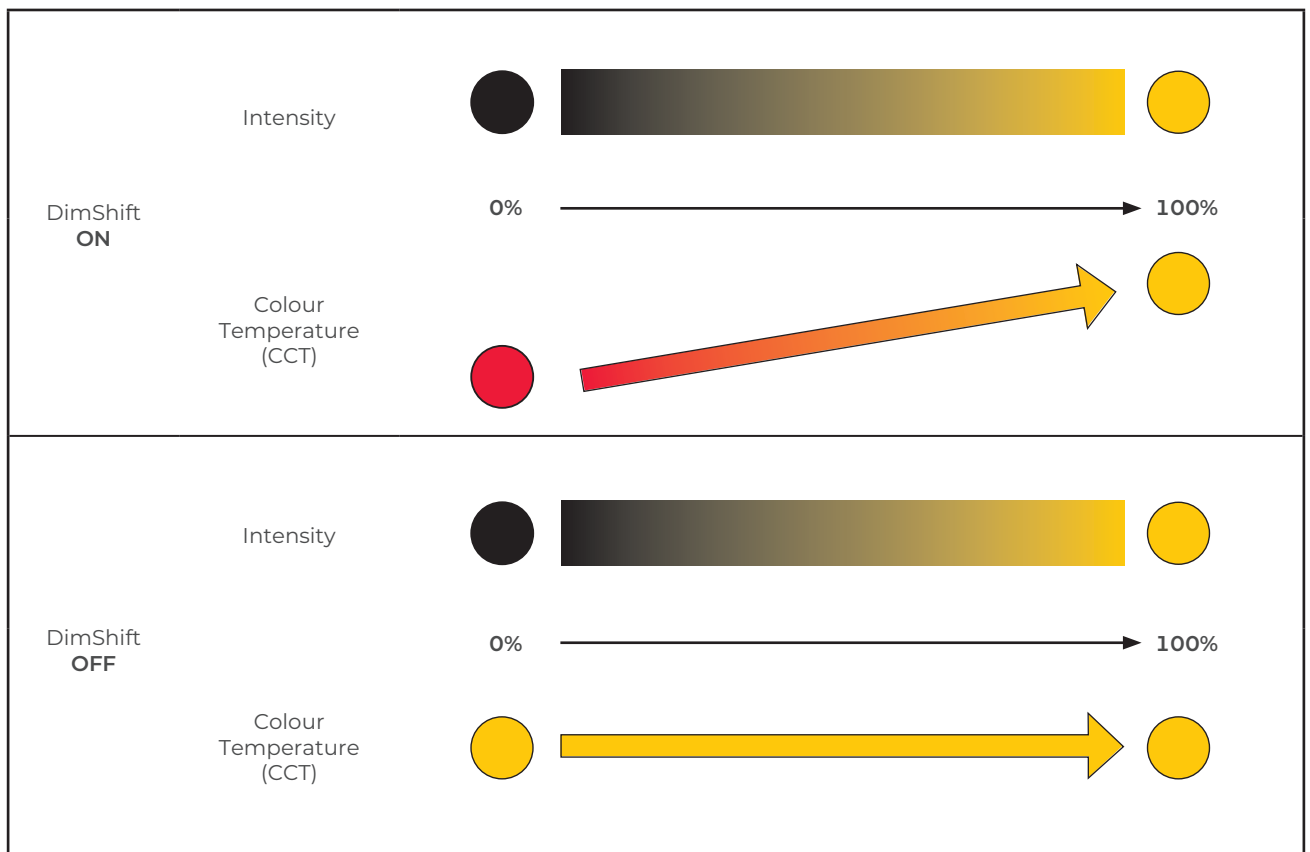
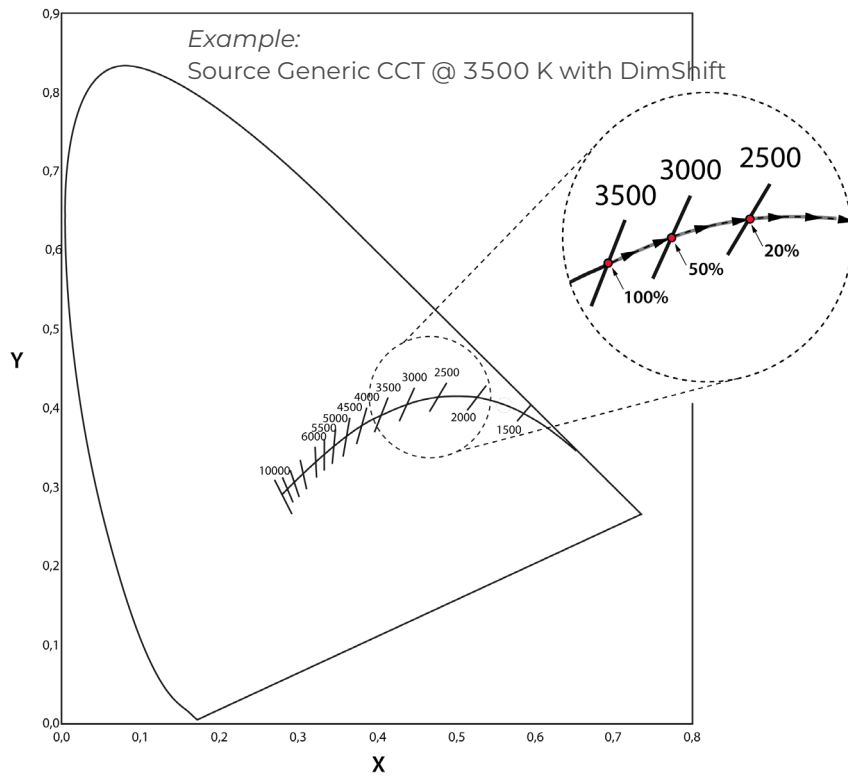

4.9.2 Control

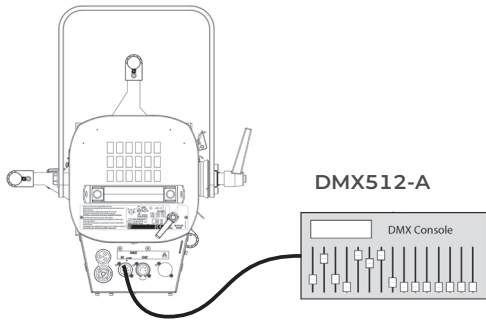

Remotely with DMX512-A protocol
 Mode 3 - 4 - 5 - 6 | Source type = White
 presets / Generic CCT
 (see 5.2.4 DMX chart for function details)

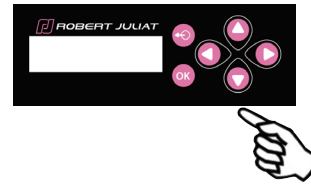

Locally with DMX mode 1 - 2 and
 Stand Alone mode - see 5.6 Home value

4.10 Beam size adjustment

4.10.1 Range

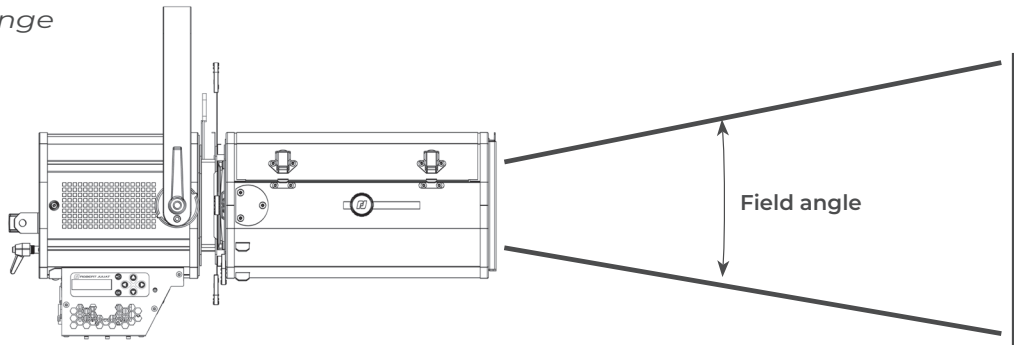

| Model | Minimum angle | Maximum angle |
|----------------------|---------------|---------------|
| 653SX 4C / 653CSX 4C | 28° | 54° |
| 654SX 4C / 654CSX 4C | 16° | 35° |
| 651SX 4C / 651CSX 4C | 11° | 26° |

4.10.2 Control

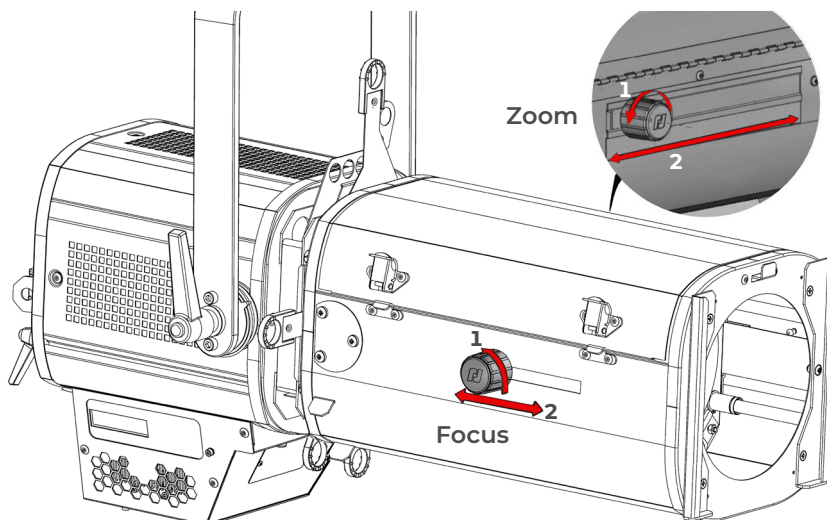

4.11.1 Range

| Function | Range |
|----------|------------------------------|
| PAN | 0 → 360° |
| TILT | TU = 0 → 63° TD = 0 → 90° |

4.11.2 Control

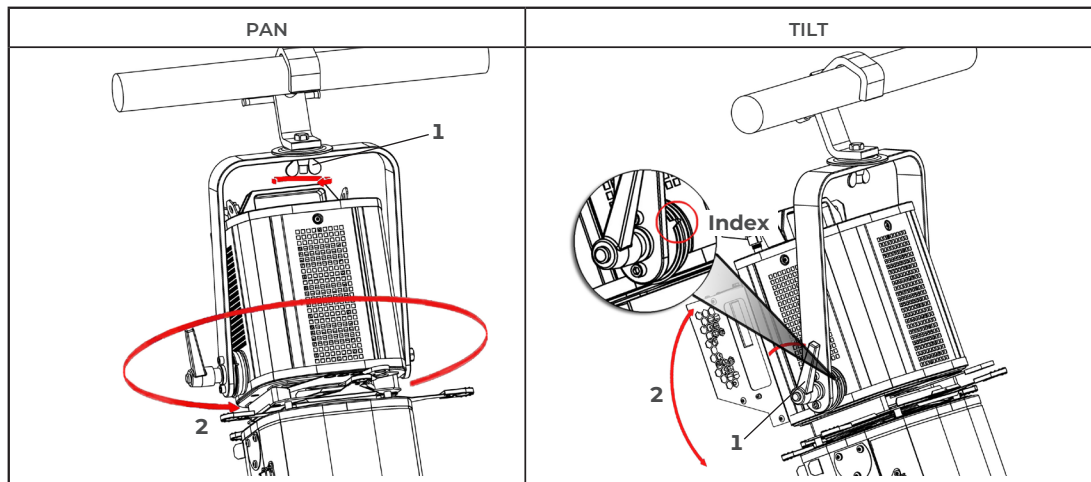

4.12 Colour and diffuser filters (gels)

Fixed colour:

| | | |
|--------------|------------------------------|---------------------------|
| Location | | |
| | 1. Front filter holder | 2. Internal filter holder |
| Type | Standard coloured gel filter | Frosted or dichroic glass |
| Dimensions | | |
| Installation | See 3.4.1 | See 3.4.3 |

4.13 Beam shaping

4.13.1 Range

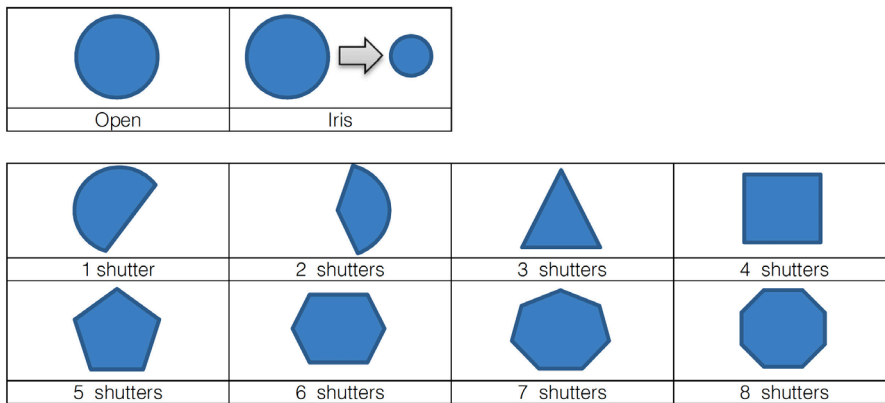

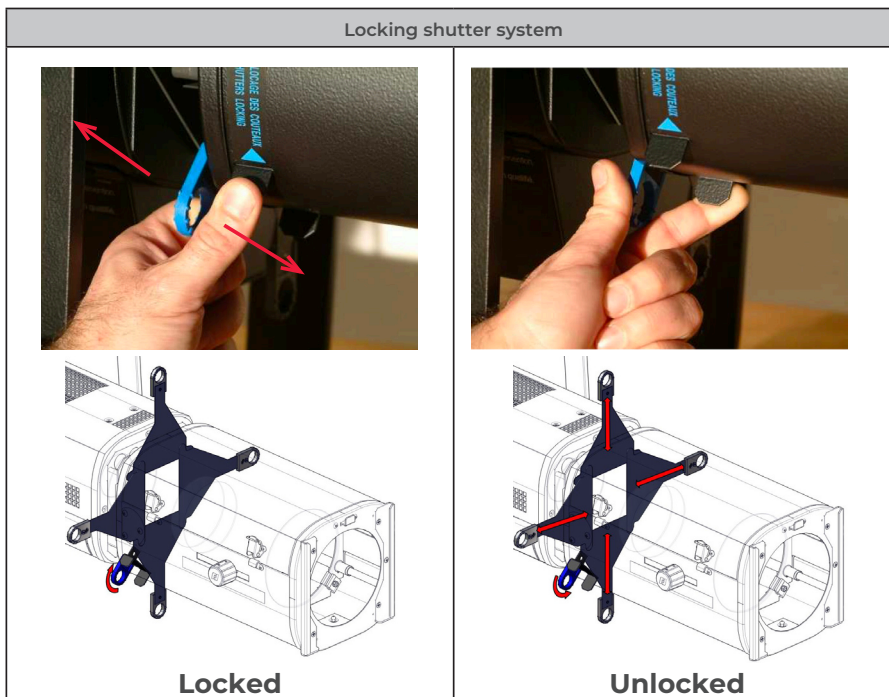

4.13.2 Control



➔ See 3.4 Accessories for gobo, iris and additional shutters installation

4.14.1 Range

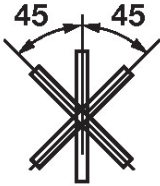
| Function | | Range |
|---|---|---|
|  |  |  |
| Gobo | Shutters | |

4.14.2 Control

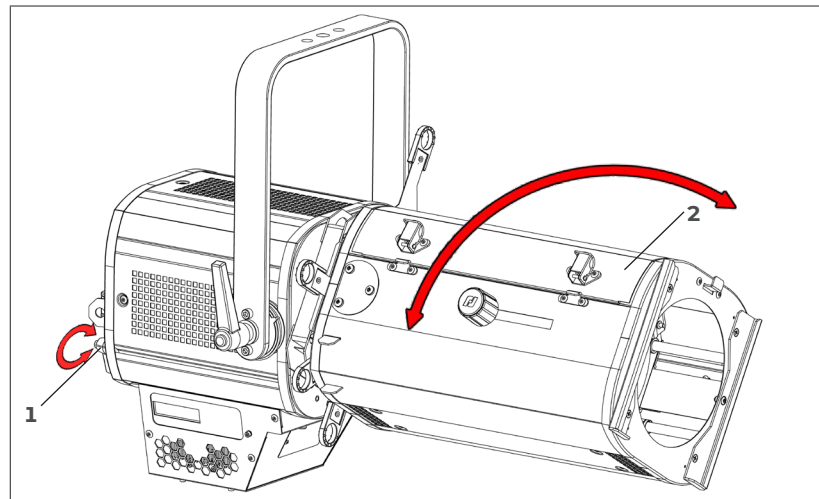





5 Controls and parameters

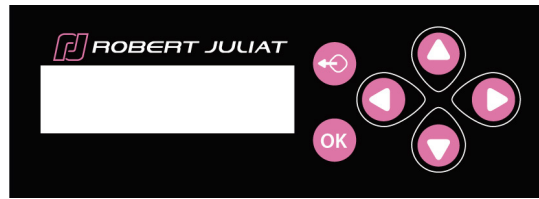

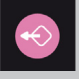
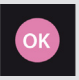
5.1 Local display and controls

5.1.1 Display



| Function | |
|---|---|
|  | Exit the current menu option and/or go back |
|  | Enter the current menu option and/or valid |
|  | Scroll through menus and/or Increase data value |
|  | Scroll through menus and/or Decrease data value |
|  | Menu down and/or Increase data value |
|  | Menu up and/or Decrease data value |

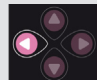

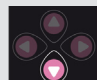

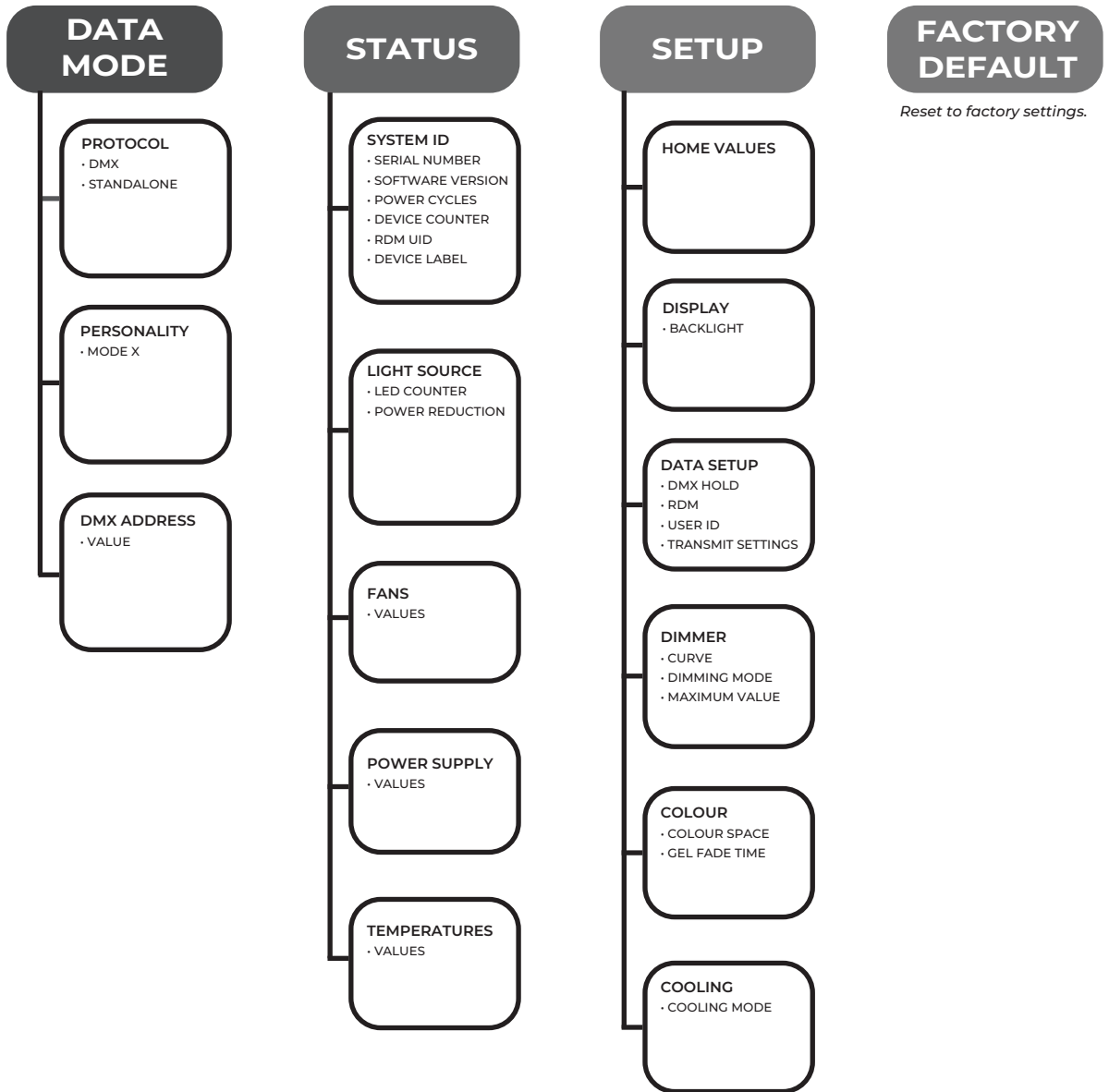
5.1.2 Home screen

| Display | Mode | Description |
|--|--|----------------------------|
| <p>Protocol selected DMX Personality</p> <p>Active mode</p> <p>Source #Gel / Colour Space</p> | Home | Main display (home screen) |
| <p>FIXTURE STATUS</p> <p>▶ TEMPERATURE LED 24°C</p> <p> TEMPERATURE DRIVERS 37°C</p> |  x1 push | Fixture Status |
| <p>PROTOCOL STATUS</p> <p>▶ DMX ADDRESS 25</p> <p> RDM ON</p> <p> PERSONALITY FULL-RGB</p> |  x1 push | Protocol Status |
| <p>ACTIVE VALUES</p> <p>▶ DIMMER 0.0 %</p> <p> STROBE: DURATION --</p> <p> ...</p> |  x1 push | Active values |

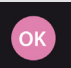

5.1.4.1 Backlight

➔ Selection in SETUP / DISPLAY / BACKLIGHT menu

| Display | Mode | Description |
|---|--------------------------|--|
| <div style="border: 1px solid black; padding: 5px;"> <p>DISPLAY BACKLIGHT</p> <p>▶ ALWAYS ON AUTO OFF AUTO OFF - ONLY WARNINGS</p> </div> | ALWAYS ON | Main display, always ON   <p>Press OK to validate</p> |
| <div style="border: 1px solid black; padding: 5px;"> <p>DISPLAY BACKLIGHT</p> <p>ALWAYS ON ▶ AUTO OFF AUTO OFF - ONLY WARNINGS</p> </div> | AUTO OFF | Main display OFF after 20 seconds   <p>Press OK to validate</p> |
| <div style="border: 1px solid black; padding: 5px;"> <p>DISPLAY BACKLIGHT</p> <p>ALWAYS ON AUTO OFF ▶ AUTO OFF - ONLY WARNINGS</p> </div> | AUTO OFF - ONLY WARNINGS | Main display OFF after 20 seconds, ON if warning information occurs   <p>Press OK to validate</p> |

5.2 DMX512 - A remote control

5.2.1 Protocol

E1.11 - 2008, USITT DMX512-A

5.2.2 Configuration

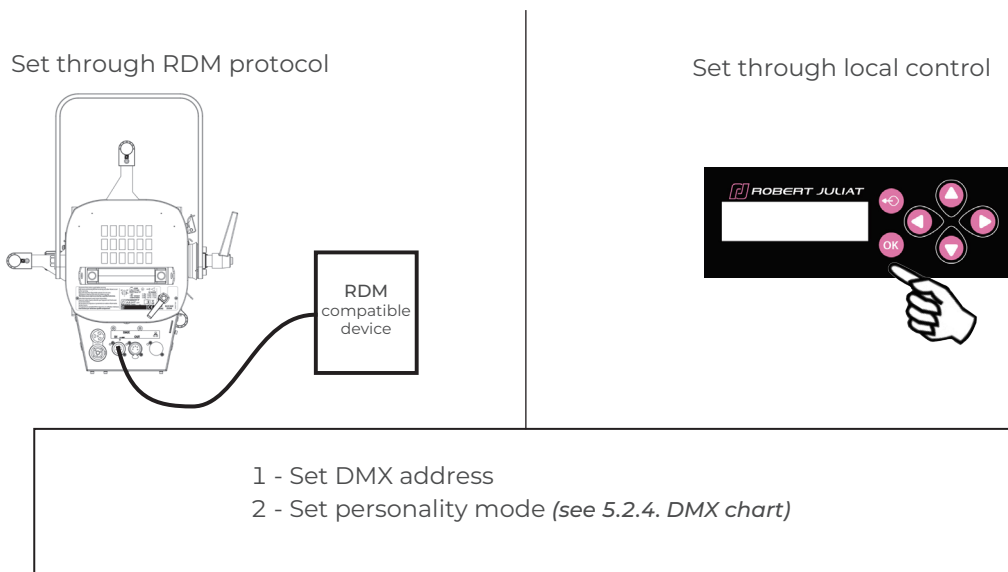

1 - Set DMX mode:

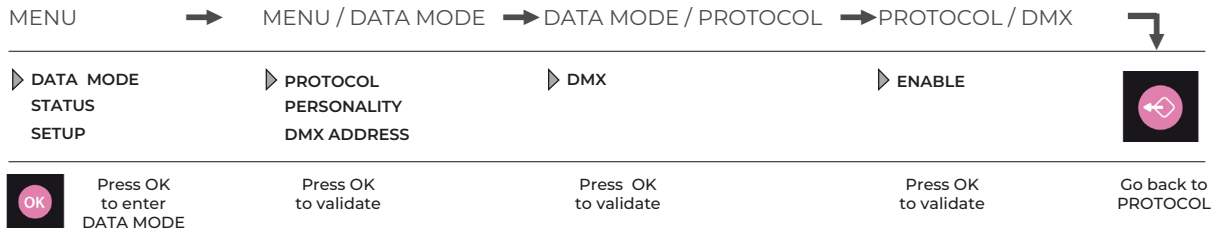

2 - Set Personality mode:

MENU / DATA MODE → DATA MODE / PERSONALITY

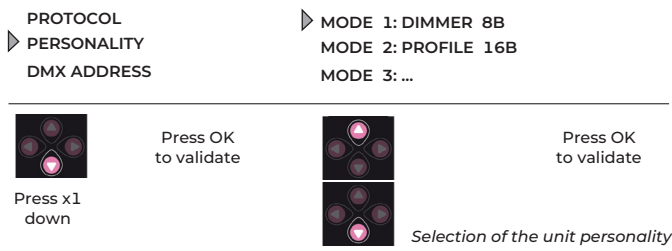

3 - Set DMX address:

MENU / DATA MODE → DATA MODE / DMX ADDRESS

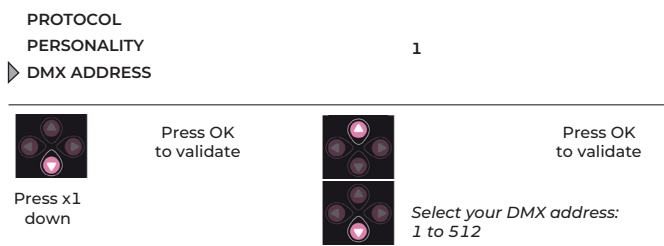

5.2.3 Parameters

5.2.3.1 DMX Hold

→ Selection in SETUP / Data Setup / DMX HOLD menu

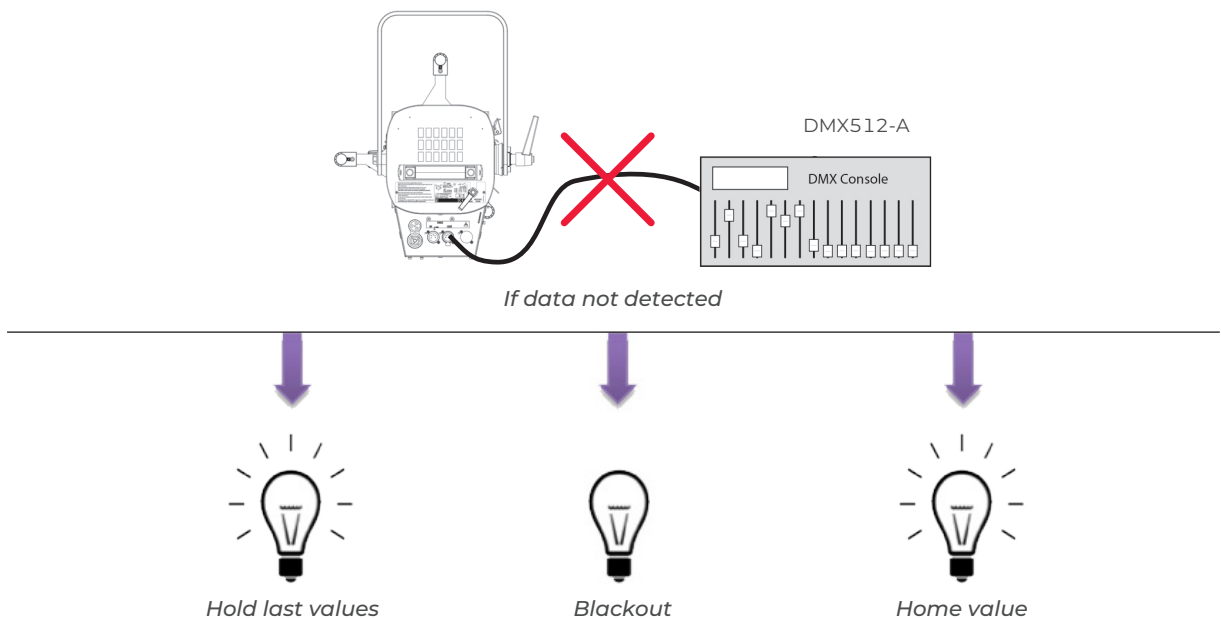

5.2.3.2 User ID

➔ Selection in SETUP / Data Setup / USER ID menu

Each unit can be identified by a User ID number – Once defined, the User ID is displayed on the Home screen.

| | | | | | | |
|--|---|---|---|--|---|---|
| Example: Installation with 6 units |  |  |  |  |  |  |
| Home screen information | ID1 @ 101 | ID2 @ 123 | ID3 @ 145 | ID4 @ 167 | ID5 @ 189 | ID6 @ 211 |
| User ID | 1 | 2 | 3 | 4 | 5 | 6 |
| DMX address | 101 | 123 | 145 | 167 | 189 | 211 |

5.2.3.3 Transfer settings

➔ Selection in SETUP / Data Setup / TRANSFER SETTINGS menu

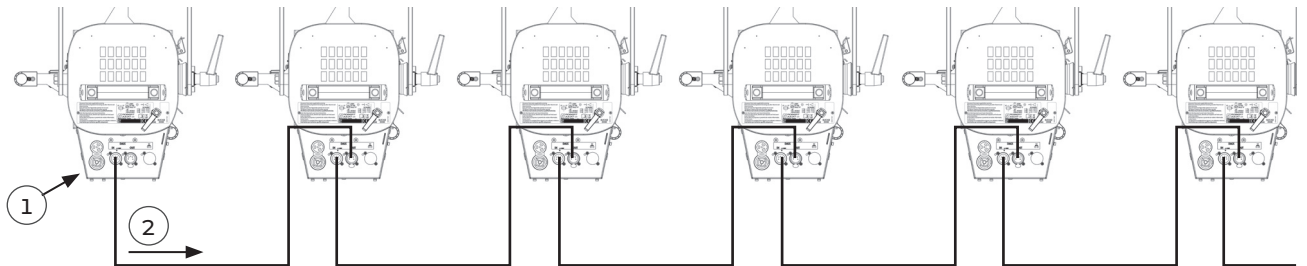

1. Setup of the first unit
2. Transmission of all parameters to the other units connected by DMX

| Mode | Function |
|---------------------|--|
| WITH DMX ADDRESS | Transmission of unit configuration : Data mode + Setup |
| WITHOUT DMX ADDRESS | Transmission of unit configuration : Data mode (excluding DMX address) + Setup |

| DMX Channel | Mode 1 | Mode 2 | Mode 3 | Mode 4 | Mode 5 | Mode 6 |
|-------------|----------|-----------------|-------------------------|-------------------------|-------------------------|-------------------------|
| | Dimmer8B | Profile16b | Full - XY | Full - HS | Full - RGB | Full - Raw |
| 1 | Dimmer | Dimmer | Dimmer | Dimmer | Dimmer | Dimmer |
| 2 | | Dimmer fine | Dimmer fine | Dimmer fine | Dimmer fine | Dimmer fine |
| 3 | | Strobe duration | Strobe duration | Strobe duration | Strobe duration | Strobe duration |
| 4 | | Strobe speed | Strobe speed | Strobe speed | Strobe speed | Strobe speed |
| 5 | | Response time | Response time | Response time | Response time | Response time |
| 6 | | Control mode | Control mode | Control mode | Control mode | Control mode |
| 7 | | | Source Type | Source Type | Source Type | Source Type |
| 8 | | | Gel: Type | Gel: Type | Gel: Type | Gel: Type |
| 9 | | | Gel: Reference | Gel: Reference | Gel: Reference | Gel: Reference |
| 10 | | | Gel: Saturation | Gel: Saturation | Gel: Saturation | Gel: Saturation |
| 11 | | | Gel: Transmission | Gel: Transmission | Gel: Transmission | Gel: Transmission |
| 12 | | | Gel: Fade Time | Gel: Fade Time | Gel: Fade Time | Gel: Fade Time |
| 13 | | | Gel: Fade Mode | Gel: Fade Mode | Gel: Fade Mode | Gel: Fade Mode |
| 14 | | | Tunable white: CCT | Tunable white: CCT | Tunable white: CCT | Tunable white: CCT |
| 15 | | | Tunable white: CCT fine | Tunable white: CCT fine | Tunable white: CCT fine | Tunable white: CCT fine |
| 16 | | | Tunable white: Delta UV | Tunable white: Delta UV | Tunable white: Delta UV | Tunable white: Delta UV |
| 17 | | | Colour: X | Colour: Hue | Colour: Red | Colour: Red |
| 18 | | | Colour: X fine | Colour: Hue fine | Colour: Red fine | Colour: Red fine |
| 19 | | | Colour: Y | Colour: Saturation | Colour: Green | Colour: Green |
| 20 | | | Colour: Y fine | Colour: Saturation fine | Colour: Green fine | Colour: Green fine |
| 21 | | | | | Colour: Blue | Colour: Blue |
| 22 | | | | | Colour: Blue fine | Colour: Blue fine |
| 23 | | | | | | Colour: Lime |
| 24 | | | | | | Colour: Lime fine |

5.2.5 DMX ranges

5.2.5.1 Strobe duration

| Range min | Range max | Function |
|-----------|-----------|--------------------------|
| 0 | 0 | Strobe OFF |
| 1 | 255 | Strobe ON - 1 ms → 20 ms |

5.2.5.2 Strobe speed

| Range min | Range max | Function |
|-----------|-----------|---------------------------|
| 0 | 255 | Frequency: 0,1 Hz → 10 Hz |

5.2.5.3 Response time

| Range min | Range max | Function |
|-----------|-----------|---|
| 0 | 0 | Default value: none tungsten source = 120ms tungsten source = 1000 W |
| 1 | 127 | Tungsten 500 W → 5000 W |
| 128 | 191 | Linear 0s → 4s |
| 192 | 255 | Linear 0s → 4s / Flash by-pass |

5.2.5.4 Control mode*

| Range min | Range max | Function |
|-----------|-----------|------------------------------|
| 0 | 0 | |
| 1 | 10 | RDM disabled |
| 11 | 20 | RDM enabled |
| 21 | 30 | Fixture Reset |
| 31 | 40 | Dimmer Curve Linear |
| 41 | 50 | Dimmer Curve Square |
| 51 | 60 | Dimmer Curve Tungsten |
| 61 | 70 | Colour Space Native |
| 71 | 80 | Colour Space sRGB / Rec. 709 |
| 81 | 90 | Colour Space Rec. 2020 |
| 91 | 100 | Colour Space ProPhoto RGB |
| 101 | 110 | Cooling mode: Silent |
| 111 | 120 | Cooling mode: Normal |
| 121 | 130 | Cooling mode: Full |
| 131 | 140 | Gel Fade Time: x1 |
| 141 | 150 | Gel Fade Time: x10 |
| 151 | 160 | Gel Fade Time: x100 |
| 161 | 255 | Not used |

(*) Function activated after 5 seconds - need to go back to zero to activate second function.

5.2.5.5 Source Type

| Range min | Range max | Function |
|-----------|-----------|--|
| 0 | 10 | Tungsten 3200 K High Quality - DimShift |
| 11 | 20 | Tungsten 3000 K High Quality - DimShift |
| 21 | 30 | Tungsten 3200 K High Quality |
| 31 | 40 | Tungsten 3000 K High Quality |
| 41 | 50 | Daylight D65 High Quality |
| 51 | 100 | Not used |
| 101 | 110 | Generic CCT - High Quality |
| 111 | 120 | Generic CCT - High Brightness |
| 121 | 130 | Generic CCT - High Quality - DimShift |
| 131 | 140 | Generic CCT - High Brightness - DimShift |
| 141 | 200 | Not used |
| 201 | 210 | Colour Mix - High Quality |
| 211 | 220 | Colour Mix - High Brightness |
| 221 | 255 | Not used |

5.2.5.6 Gel Type

| Range min | Range max | Function | Gel Type | Comments |
|-----------|-----------|----------|------------------------|---|
| 0 | 4 | Wheel 1 | Basics | Only when Source type = "Calibrated whites" & "Generic CCT" |
| 5 | 9 | Wheel 2 | Numeric: 002 --> 111 | |
| 10 | 14 | Wheel 3 | Numeric: 113 --> 181 | |
| 15 | 19 | Wheel 4 | Numeric: 182 --> 328 | |
| 20 | 24 | Wheel 5 | Numeric: 332 --> 710 | |
| 25 | 29 | Wheel 6 | Numeric: 711 --> 799 | |
| 30 | 34 | Wheel 7 | Chroma: 048 --> 719 | |
| 35 | 39 | Wheel 8 | Chroma: 711 --> 504 | |
| 40 | 44 | Wheel 9 | Chroma: 730--> 007 | |
| 45 | 49 | Wheel 10 | Chroma: 765 --> 789 | |
| 50 | 54 | Wheel 11 | Chroma: 787 --> 344 | |
| 55 | 59 | Wheel 12 | Cosmetic & Corrections | |
| 60 | 64 | Wheel 13 | Dalis selection | |
| 65 | 254 | | | Not used |

5.2.5.7 Gel references

➔ See annex for reference details

5.2.5.8 Gel Saturation

| Range min | Range max | Function | Comments |
|-----------|-----------|----------|---|
| 0 | 255 | 0 ➔ 100% | Only when Source type = "Calibrated whites" & "Generic CCT" |

5.2.5.9 Gel Transmission

| Range min | Range max | Function | Comments |
|-----------|-----------|----------|---|
| 0 | 255 | 0 ➔ 100% | Only when Source type = "Calibrated whites" & "Generic CCT" |

5.2.5.10 Gel Fade Time

| Range min | Range max | Function | Comments |
|-----------|-----------|-------------|---|
| 0 | 0 | 0s | |
| 1 | 255 | 0,1 ➔ 25,5s | Only when Source type = "Calibrated whites" & "Generic CCT" |

| Range min | Range max | Mode | Comments |
|-----------|-----------|-------------------------------|---|
| 0 | 10 | Direct XY + Limit Brightness | Only when Source type = "Calibrated whites" & "Generic CCT" |
| 11 | 20 | Direct XY | |
| 21 | 30 | Open Frame + Limit Brightness | |
| 31 | 40 | Open Frame | |
| 41 | 50 | Through Black | |
| 51 | 255 | Reserved / Off (0 s) | |

5.2.5.12 CCT

| Range min | Range max | Mode | Comments |
|-----------|-----------|-----------------|---------------------------------------|
| 0 | 255 | 1700K → 10 000K | Only when Source type = "Generic CCT" |

5.2.5.13 DeltaUV

| Range min | Range max | Mode | Comments |
|-----------|-----------|--------------------------------|---------------------------------------|
| 0 | 126 | Magenta correction: - 100% T 0 | Only when Source type = "Generic CCT" |
| 127 | 127 | Black body locus: 0 | |
| 128 | 255 | Green correction: 0 → 100% | |

5.2.5.14 Colour CIE x

| Range min | Range max | Mode | Comments |
|-----------|-----------|--------------|--------------------------------------|
| 0 | 255 | y=0 → y=0.85 | Only when Source type = "Colour Mix" |

5.2.5.15 Colour CIE y

| Range min | Range max | Mode | Comments |
|-----------|-----------|--------------|--------------------------------------|
| 0 | 255 | y=0 → y=0.85 | Only when Source type = "Colour Mix" |

5.3 RDM remote control

5.3.1 Protocol

ANSI E1.20 – 2010 / ANSI E1.37 - 1

For more information on the RDM protocol: <http://www.rdmprotocol.org/>

| PID | Description | Standard | Get | Set | 4C |
|------------------------------|--------------------------------|----------|-----|-----|--------|
| | | | | | b 6262 |
| Network Management | | | | | |
| 00 01 | DISCOVERY_UNIQUE_BRANCH | E1.20* | | | ✓ |
| 00 02 | DISCOVERY_MUTE | E1.20 | | ✓ | ✓ |
| 00 03 | DISCOVERY_UNMUTE | E1.20 | | ✓ | ✓ |
| 00 15 | COMMUNICATION_STATUS | E1.20 | ✓ | ✓ | ✓ |
| Status Collection | | | | | |
| 00 31 | STATUS_ID_DESCRIPTION | E1.20 | ✓ | | ✓ |
| 00 32 | CLEAR_STATUS_ID | E1.20 | | ✓ | ✓ |
| RDM Information | | | | | |
| 00 50 | SUPPORTED_PARAMETERS | E1.20* | ✓ | | ✓ |
| Product Information | | | | | |
| 00 60 | DEVICE_INFO | E1.20* | ✓ | | ✓ |
| 00 80 | DEVICE_MODEL_DESCRIPTION | E1.21 | ✓ | | ✓ |
| 00 81 | MANUFACTURER_LABEL | E1.20 | ✓ | | ✓ |
| 00 82 | DEVICE_LABEL | E1.20 | ✓ | ✓ | ✓ |
| 00 90 | FACTORY_DEFAULTS | E1.20 | ✓ | ✓ | ✓ |
| 00 C0 | SOFTWARE_VERSION_LABEL | E1.20* | ✓ | | ✓ |
| 00 C1 | BOOT_SOFTWARE_VERSION_ID | E1.20 | ✓ | | ✓ |
| 00 C2 | BOOT_SOFTWARE_VERSION_LABEL | E1.20 | ✓ | | ✓ |
| DMX512 Setup | | | | | |
| 00 E0 | DMX512_PERSONALITY | E1.20 | ✓ | ✓ | ✓ |
| 00 E1 | DMX512_PERSONALITY_DESCRIPTION | E1.20 | ✓ | | ✓ |
| 00 F0 | DMX512_STARTING_ADDRESS | E1.20* | ✓ | ✓ | ✓ |
| Sensors | | | | | |
| 02 00 | SENSOR_DEFINITION | E1.20 | ✓ | | ✓ |
| 02 01 | SENSOR_VALUE | E1.20 | ✓ | | ✓ |
| 02 02 | SENSOR_RECORD | E1.20 | ✓ | ✓ | ✓ |
| Dimmer Settings | | | | | |
| 03 40 | DIMMER_INFO | E1.37-1 | ✓ | | ✓ |
| 03 41 | MINIMUM_LEVEL | E1.37-1 | ✓ | ✓ | ✓ |
| 03 42 | MAXIMUM_LEVEL | E1.37-1 | ✓ | ✓ | ✓ |
| Power / Lamp Settings | | | | | |
| 04 00 | DEVICE_HOURS | E1.20 | ✓ | | ✓ |
| 04 01 | LAMP_HOURS | E1.20 | ✓ | ✓ | ✓ |
| 04 02 | LAMP_STRIKE | E1.20 | ✓ | ✓ | ✓ |
| 04 05 | DEVICE_POWER_CYCLE | E1.20 | ✓ | | ✓ |
| Display Settings | | | | | |
| Control | | | | | |
| 10 00 | IDENTIFY_DEVICE | E1.20* | ✓ | ✓ | ✓ |
| 10 01 | RESET_DEVICE | E1.20 | | ✓ | ✓ |

5.3.3 Parameters

RDM: ON/OFF

➔ Selection in SETUP / Data Setup / RDM menu

5.4 Fan cooling modes

5.4.1 Range

| Mode | Fan Speed |
|---------------|--|
| SILENT | Minimum – constant speed |
| NORMAL | Regulated – depending on ambient temperature |
| FULL | Maximum – constant speed |

5.4.2 Control

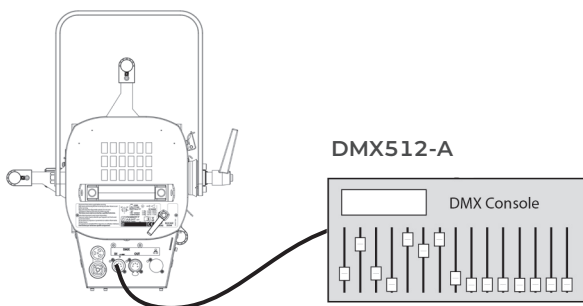

Remotely by DMX512-A
 Mode 2 - 3 - 4 - 5 - 6
 (see 5.2.4 DMX chart for function details)

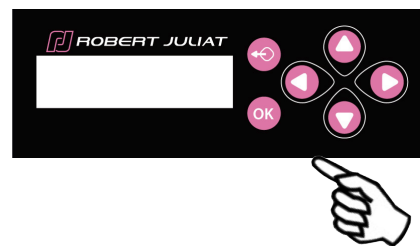

Locally ➔ selection in
 SETUP / COOLING

5.5.1 Trouble shooting

• During unit initialisation (power up) – up to 5 seconds:

| 1 DMX OUT | 2 DMX IN | Description |
|-----------------|-------------|--|
| | | Error |
| | | No DMX protocol detected |
| | | DMX protocol detected |
| | | DMX protocol detected + RDM protocol activated |

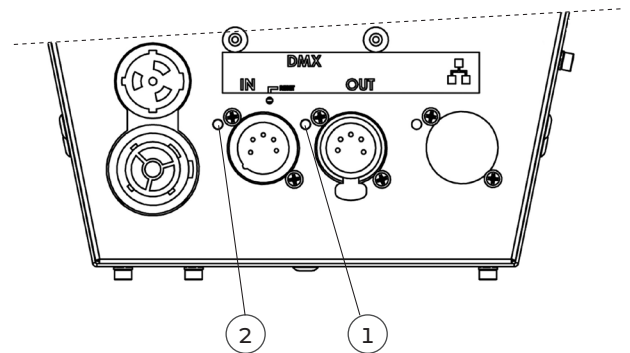

5.5.2 Parameters

5.5.2.1 Auto-OFF

➔ Set through RDM protocol or local control

| Mode | Description |
|-----------------------|---|
| Always ON | Feedback LED, always ON |
| Timer without warning | Feedback LED OFF after 20 seconds ERROR LED always ON |
| Timer with warning | Feedback LED OFF after 20 seconds ON , if warning information occurs ERROR LED always ON |

5.6.1 Range

➔ Selection in SETUP / HOME VALUES menu

If the function is not controlled by DMX, HOME VALUE is automatically activated

| Functions * | DMX Dimmer mode (mode 1) | DMX Profile mode (mode 2) | DMX Full mode (mode 3-4-5-6) | Stand Alone |
|-------------------------|--------------------------|---------------------------|------------------------------|-------------|
| Dimmer | DMX value | DMX value | DMX value | Home value |
| Strobe duration | NA | DMX value | DMX value | NA |
| Strobe speed | NA | DMX value | DMX value | NA |
| Response time | Home value | DMX value | DMX value | NA |
| Control mode | NA | DMX value | DMX value | NA |
| Source Type | Home value | Home value | DMX value | Home value |
| Gel: Type | Home value | Home value | DMX value | Home value |
| Gel: Reference | Home value | Home value | DMX value | Home value |
| Gel: Saturation | Home value | Home value | DMX value | Home value |
| Gel: Transmission | Home value | Home value | DMX value | Home value |
| Gel: Fade time | NA | NA | DMX value | NA |
| Gel: Fade mode | NA | NA | DMX value | NA |
| Tunable white: CCT | Home value | Home value | DMX value | Home value |
| Tunable white: Delta UV | Home value | Home value | DMX value | Home value |
| Colour: Red | Home value | Home value | DMX value | Home value |
| Colour: Green | Home value | Home value | DMX value | Home value |
| Colour: Blue | Home value | Home value | DMX value | Home value |
| Colour: x | Home value | Home value | DMX value | Home value |
| Colour: y | Home value | Home value | DMX value | Home value |
| Colour : Hue | Home value | Home value | DMX value | Home value |
| Colour: Saturation | Home value | Home value | DMX value | Home value |

(*) Functions are displayed depending on DMX mode and Source Type selected
(example : Red, Green, Blue are available if Source Type = Colour Mix)

6.1 Preventive maintenance

6.1.1 Frequency

General maintenance should be performed at least once a year or more frequently if the equipment is operated in adverse conditions (smoke, heat, humidity, touring, etc.).

6.1.2 General cleaning

Remove dust from the unit.
Front glasses can be cleaned with solutions containing alcohol.

6.1.3 General visual check

- No trace of heat.
- No loose contacts.
- No missing parts.
- Tighten mechanical assemblies (screws, bolts and nuts, etc.).

6.1.4 LED source



- Do not touch the surface of the LED source (no contact with your hands or any tools)
- See section 6.1.7 for the removal and installation procedure of the LED module.
- Do not put compressed air directly on the source.
- Contact a certified RJ distributor in case of residuals or other objects located on the surface of the LED source.

6.1.5 Optics

- Only use solutions containing alcohol to clean optical parts (lenses).
- To clean the optical parts, use a soft cloth in combination with distilled water or isopropyl alcohol recommended for coated optics. Do not use any cleaning product that contains solvents or abrasives, as these can cause surface damage.
- Dry with a soft lint-free cloth.

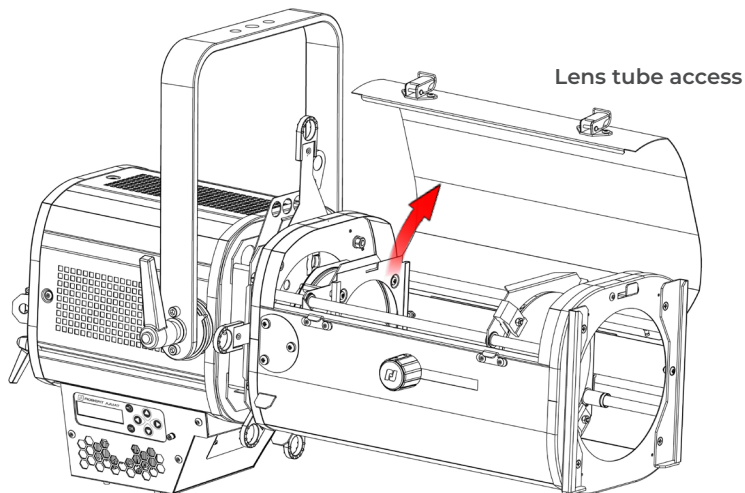

6.1.6 LED house cleaning

Inner parts & lens holder access:

- To clean the optical parts, use a soft cloth in combination with distilled water or isopropyl alcohol recommended for coated optics. Do not use any cleaning product that contains solvents or abrasives, as these can cause surface damage.
- Dry with a soft lint-free cloth.
- The double condenser system (aspheric and biconvex lenses) can easily be removed, without tools, by removing the two M6 nuts. The complete holder can then be removed for cleaning, see section 3.4.2.

How to remove the Sully LED module:

1. We recommend you place your luminaire on a flat clean surface.
Disconnect from the mains before servicing.

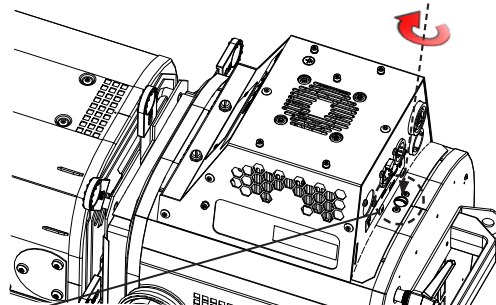
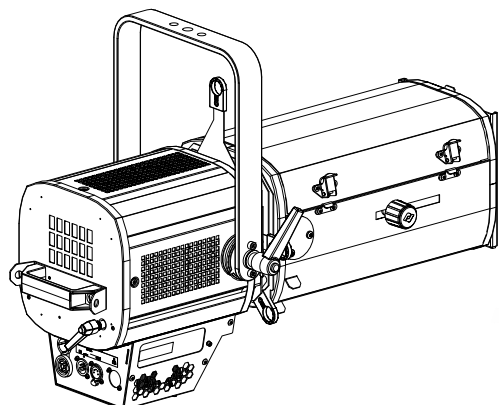

2. Unlock the quarter turn screw with a flat screwdriver.

3. Remove the two screws with a flat screwdriver.

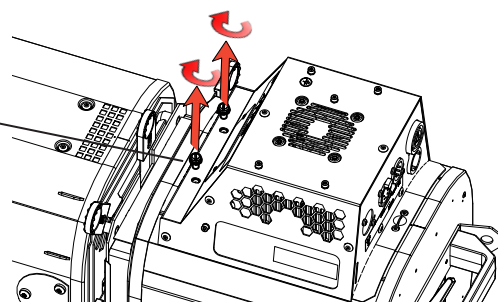

4. Slightly slide out the LED module and remove the earth attachment before removing it completely from its housing.

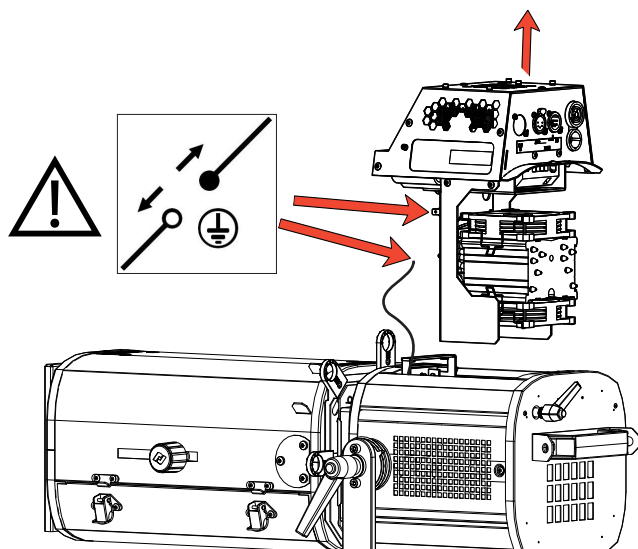

5. Carefully place the LED module on a flat clean surface.

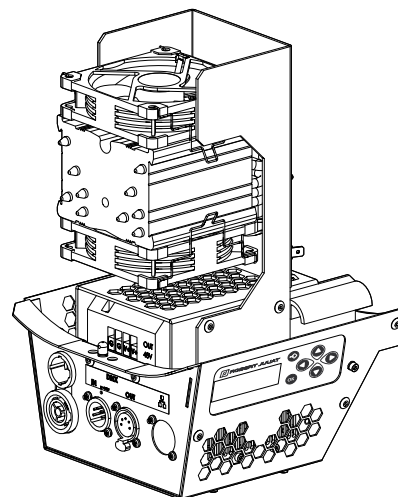

Sully LED module installation:

6. Extend the hinge to its maximum position to make it easily accessible.
Insert the Sully 4C LED module into your luminaire, making sure it is positioned vertically to enable the LED module to enter the lamp house correctly.

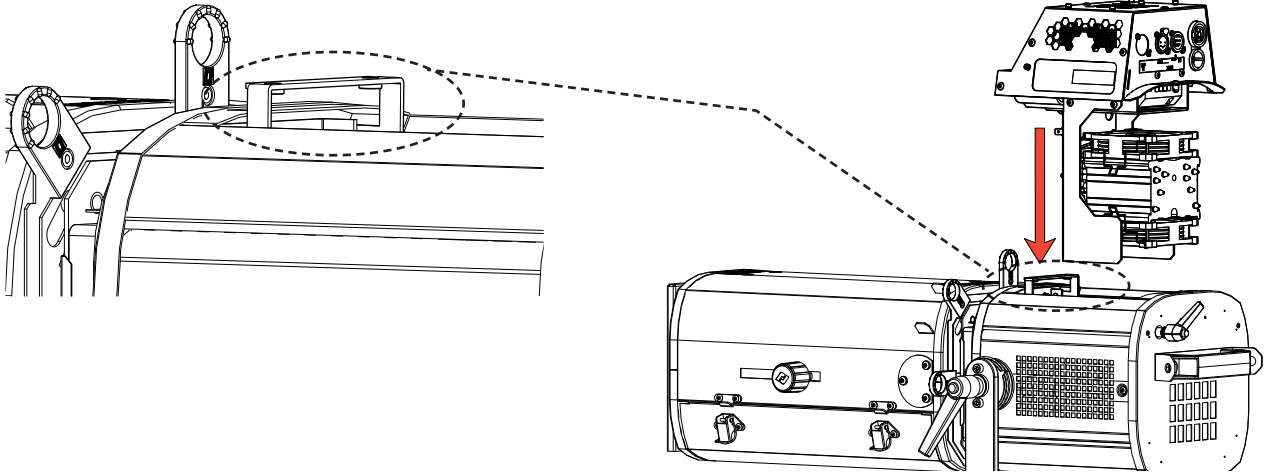

7. Connect the ground connection (faston tab terminal) to the Sully 4C LED module.



- Tighten the faston tab terminal.

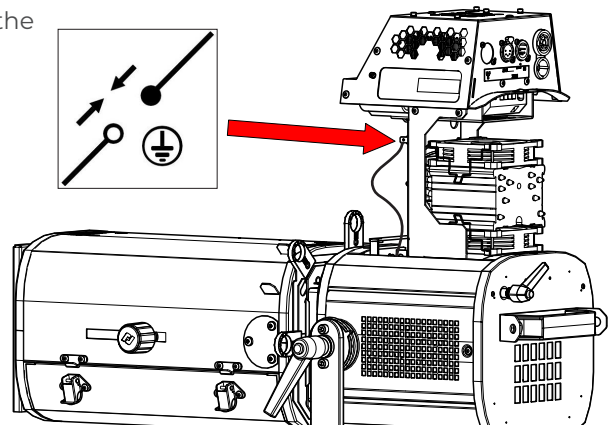

8. Once the Sully 4C LED module is fully inserted, tighten the two screws nearest the shutter gate.
Re-tighten the quarter turn screw located at the back of the lamp base to lock the LED module securely into your luminaire.

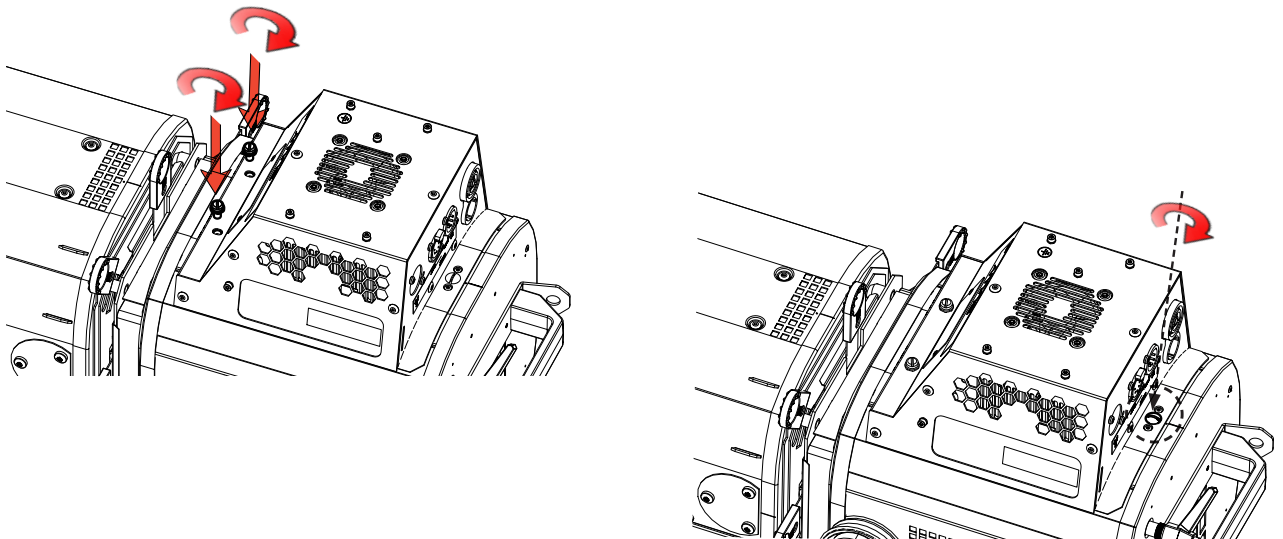



In case of problem, contact RJ distributor with the following information:

- Model, version and serial number of the product.
- From the menu status:
 - Software version
 - LED board IDs
 - Device hours
- Description of the problem.

6.3 Electronic thermal management system

In case of overheating, light intensity will be reduced by the system.

Power reduction and temperature values are available by using a RDM protocol compatible device or in the "Status" menu of the fixture.

6.4 Firmware update

A USB/DMX dongle is required and be connected to your PC (no Mac compatibility at the present time) from an USB port to the DMX input of Sully 4C.

USB-Dongle compatibility:

- All Enttec USB-DMX Dongle
- All USB-DMX Dongle based on FTDI chip

Software Platform compatibility:

- Windows 7/8/10

1. Extract the content of folder "Firmware Updater" (including subfolder) to your PC.
2. Connect USB-DMX dongle device via USB to your PC.
3. Connect one or more Fixtures via DMX Cable.
4. Run "RobertJuliat Firmware Updater.exe"
5. The USB-DMX device should be shown in the lower left corner as "Current interface: FTDI FIUP012021..."
If not, click "Interfaces" - "Refresh Interfaces List".
6. Click "Select File" and select the desired update file (*.dmx)
7. Click "Start"
8. All fixtures of the type specified in the update file will automatically enter in Bootloader mode and update their firmware



Product
Updates:



6.5 Factory defaults

6.5.1 Modes

| Mode | Description |
|------------------|--|
| Factory defaults | Set all user parameters to factory default value |

6.5.2 Control

Set to factory defaults /
reset through RDM protocol

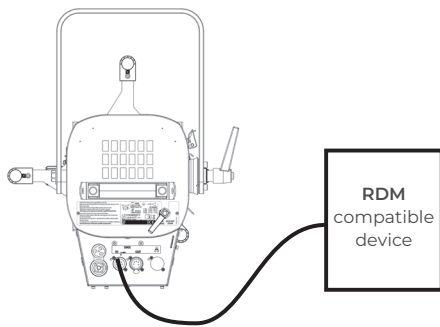

Set to factory defaults /
reset through local control

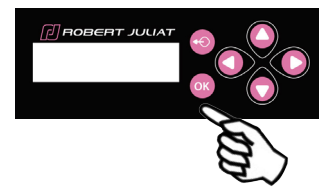

Annex 1 - Gel References

| Range # | Range min | Range max | 1. Basics | 2. Numeric: 002 --> 111 | 3. Numeric: 113 --> 181 | 4. Numeric: 182 --> 328 | 5. Numeric: 332 --> 710 | 6. Numeric: 711 --> 799 | 7. Chroma: 048 --> 719 | 8. Chroma: 711 --> 504 | 9. Chroma: 730--> 007 | 10. Chroma: 765 --> 789 | 11. Chroma: 787 --> 344 | 12. Cosmetic & Corrections | 13. Dalls selection |
|---------|-----------|-----------|-----------|-------------------------|-------------------------|-------------------------|-------------------------|-------------------------|------------------------|------------------------|-----------------------|-------------------------|-------------------------|----------------------------|---------------------|
| 1 | 0 | 4 | Open | Open | Open | Open | Open | Open | Open | Open | Open | Open | Open | Open | Open |
| 2 | 5 | 9 | 2 | 2 | 113 | 182 | 332 | 711 | 48 | 711 | 730 | 765 | 787 | 184 | 203 |
| 3 | 10 | 14 | 7 | 3 | 115 | 183 | 341 | 712 | 797 | 500 | 242 | 102 | 27 | 185 | 202 |
| 4 | 15 | 19 | 26 | 4 | 116 | 192 | 343 | 713 | 49 | 501 | 243 | 550 | 29 | 186 | 201 |
| 5 | 20 | 24 | 27 | 7 | 117 | 193 | 344 | 714 | 126 | 708 | 213 | 513 | 26 | 187 | 200 |
| 6 | 25 | 29 | 35 | 8 | 118 | 194 | 345 | 715 | 798 | 53 | 246 | 514 | 24 | 188 | 204 |
| 7 | 30 | 34 | 48 | 9 | 119 | 195 | 352 | 716 | 701 | 502 | 731 | 100 | 157 | 189 | 205 |
| 8 | 35 | 39 | 88 | 10 | 120 | 196 | 353 | 719 | 345 | 503 | 733 | 10 | 107 | 190 | 206 |
| 9 | 40 | 44 | 100 | 13 | 121 | 197 | 354 | 721 | 703 | 203 | 245 | 101 | 109 | 191 | 241 |
| 10 | 45 | 49 | 101 | 15 | 122 | 198 | 363 | 722 | 52 | 600 | 244 | 767 | 176 | 217 | 174 |
| 11 | 50 | 54 | 105 | 17 | 124 | 199 | 366 | 723 | 704 | 601 | 138 | 104 | 790 | 49 | 161 |
| 12 | 55 | 59 | 106 | 19 | 126 | 200 | 441 | 724 | 170 | 61 | 88 | 15 | 36 | 65 | 165 |
| 13 | 60 | 64 | 108 | 20 | 127 | 201 | 442 | 725 | 136 | 63 | 505 | 768 | 192 | 63 | 353 |
| 14 | 65 | 69 | 115 | 21 | 128 | 202 | 443 | 727 | 169 | 202 | 738 | 179 | 111 | 58 | 079 |
| 15 | 70 | 74 | 116 | 22 | 130 | 203 | 444 | 728 | 702 | 281 | 121 | 20 | 794 | 172 | 723 |
| 16 | 75 | 79 | 117 | 24 | 131 | 204 | 500 | 729 | 137 | 201 | 122 | 770 | 2 | 141 | 723 |
| 17 | 80 | 84 | 118 | 25 | 132 | 205 | 501 | 730 | 194 | 283 | 89 | 105 | 328 | 146 | 119 |
| 18 | 85 | 89 | 119 | 26 | 134 | 206 | 502 | 731 | 58 | 366 | 139 | 777 | 795 | 130 | 363 |
| 19 | 90 | 94 | 120 | 27 | 135 | 207 | 503 | 733 | 180 | 174 | 90 | 512 | 128 | 129 | 122 |
| 20 | 95 | 99 | 122 | 29 | 136 | 208 | 504 | 735 | 343 | 161 | 736 | 652 | 793 | 149 | 124 |
| 21 | 100 | 104 | 124 | 35 | 137 | 212 | 505 | 736 | 700 | 68 | 740 | 287 | 332 | 104 | 138 |
| 22 | 105 | 109 | 126 | 36 | 138 | 213 | 506 | 738 | 181 | 132 | 741 | 286 | 148 | 237 | 134 |
| 23 | 110 | 114 | 128 | 39 | 139 | 218 | 507 | 740 | 707 | 165 | 642 | 204 | 46 | 97 | 147 |
| 24 | 115 | 119 | 131 | 46 | 140 | 219 | 508 | 741 | 706 | 352 | 643 | 441 | 113 | 240 | 101 |
| 25 | 120 | 124 | 135 | 48 | 141 | 223 | 511 | 742 | 709 | 143 | 650 | 744 | 127 | 132 | 105 |
| 26 | 125 | 129 | 138 | 49 | 142 | 230 | 512 | 744 | 142 | 196 | 746 | 285 | 748 | 131 | 328 |
| 27 | 130 | 134 | 139 | 52 | 143 | 232 | 513 | 746 | 199 | 727 | 653 | 236 | 110 | 176 | 780 |
| 28 | 135 | 139 | 141 | 53 | 144 | 236 | 514 | 747 | 508 | 141 | 511 | 604 | 247 | 136 | 182 |
| 29 | 140 | 144 | 144 | 58 | 147 | 237 | 525 | 748 | 799 | 183 | 742 | 651 | 35 | 98 | 026 |
| 30 | 145 | 149 | 153 | 61 | 148 | 238 | 550 | 763 | 71 | 118 | 208 | 17 | 153 | 102 | 027 |
| 31 | 150 | 154 | 157 | 63 | 151 | 241 | 600 | 764 | 713 | 724 | 207 | 134 | 4 | 103 | 021 |
| 32 | 155 | 159 | 164 | 68 | 152 | 242 | 601 | 765 | 710 | 144 | 232 | 147 | 151 | 109 | 102 |
| 33 | 160 | 164 | 174 | 71 | 153 | 243 | 602 | 767 | 198 | 725 | 230 | 776 | 154 | 108 | 118 |
| 34 | 165 | 169 | 176 | 75 | 154 | 244 | 603 | 768 | 716 | 117 | 156 | 773 | 248 | 105 | 115 |
| 35 | 170 | 174 | 179 | 79 | 156 | 245 | 604 | 770 | 195 | 140 | 237 | 108 | 249 | 227 | 197 |
| 36 | 175 | 179 | 180 | 85 | 157 | 246 | 642 | 773 | 715 | 353 | 747 | 8 | 279 | 233 | 197 |
| 37 | 180 | 184 | 181 | 88 | 158 | 247 | 643 | 776 | 723 | 172 | 238 | 779 | 3 | 234 | 181 |
| 38 | 185 | 189 | 182 | 89 | 159 | 248 | 650 | 777 | 721 | 354 | 152 | 158 | 218 | 238 | 139 |
| 39 | 190 | 194 | 200 | 90 | 161 | 249 | 651 | 778 | 120 | 729 | 162 | 21 | 278 | 235 | 797 |
| 40 | 195 | 199 | 201 | 100 | 162 | 278 | 652 | 779 | 363 | 116 | 506 | 778 | 159 | 66 | 002 |
| 41 | 200 | 204 | 202 | 101 | 164 | 279 | 653 | 780 | 85 | 115 | 9 | 780 | 223 | 175 | Open |
| 42 | 205 | 209 | 203 | 102 | 165 | 281 | 700 | 781 | 119 | 327 | 205 | 22 | 444 | 171 | Open |
| 43 | 210 | 214 | 204 | 103 | 166 | 283 | 701 | 787 | 722 | 124 | 442 | 135 | 602 | 170 | Open |
| 44 | 215 | 219 | 205 | 104 | 169 | 285 | 702 | 789 | 79 | 735 | 13 | 781 | 603 | 173 | Open |
| 45 | 220 | 224 | 206 | 105 | 170 | 286 | 703 | 790 | 714 | 323 | 764 | 25 | 130 | 142 | Open |
| 46 | 225 | 229 | 219 | 106 | 172 | 287 | 704 | 793 | 75 | 322 | 103 | 507 | 39 | 147 | Open |
| 47 | 230 | 234 | 244 | 107 | 174 | 322 | 706 | 794 | 525 | 131 | 206 | 19 | 166 | 166 | Open |
| 48 | 235 | 239 | 245 | 108 | 176 | 323 | 707 | 795 | 197 | 219 | 443 | 164 | 193 | 193 | Open |
| 49 | 240 | 244 | 332 | 109 | 179 | 325 | 708 | 797 | 712 | 241 | 763 | 182 | 325 | 325 | Open |
| 50 | 245 | 249 | 702 | 110 | 180 | 327 | 709 | 798 | 200 | 728 | 212 | 106 | 341 | 341 | Open |
| 51 | 250 | 254 | 738 | 111 | 181 | 328 | 710 | 799 | 719 | 504 | 7 | 789 | 344 | 344 | Open |
| 52 | 255 | 255 | Open | Open | Open | Open | Open | Open | Open | Open | Open | Open | Open | Open | Open |

Annex 2 - Home values

1. General:





"Home Values" represents a set of parameters manually entered into the device via the keypad in order to restore a predefined setup when a full control of the fixture by DMX is not present, available or allowed. Those home values are used in the following cases:

- ➔ Loss of DMX signal data: From Menu - "Set Up" then "Data Setup" and Select "**DMX Hold**"
- ➔ Standalone Mode : From Menu "Data Mode" then "Protocol" and Select "**Standalone**"
- ➔ 16 bit Personality Mode: From Menu "Data Mode" then "Personality" and Select "**Profile 16 bit**"
- ➔ 8 bit Personality Mode: From Menu "Data Mode" then "Personality" and Select "**Dimmer 8 bit**"

2. Set up the "Dimmer 8 bit" mode:

In "Dimmer 8 bit" mode , the default source is a 3200K halogen source with DimShift (reddening of the filament), halogen dimming curve and a response time corresponding to a 1000W lamp.

BASIC SETUP IN 4 STEPS

| Display | Mode | Description |
|--|---|---|
| DATA MODE Personality Mode 1 : Dimmer 8 bit |  | Select Personality Mode: Mode 1 - Dimmer 8 Bit : 1 Channel DMX |
| DATA MODE DMX address 001 - 512 |  | Select DMX Address |
| SET UP Home values Gel Type |  | Select the Color Wheel according to your chosen Gel reference |
| SET UP Home values Preset colour |  | Select your Gel reference from the dropdown list |

OTHER PARAMETERS AVAILABLE

| Display | Mode | Description |
|---|---|--|
| SET UP Home values Dimmer Source type Colour mix Response time Tungsten power Gel saturation Gel transmission Tunable white CCT Tunable white delta UV Color Red Color Green Color Blue |  | All other parameters are available according to the source type selected and technical choices |